

A ccessories



Technische Informationen
technical information





Accessories

For all of our shower hinges or –systems we have as well the suitable accessory. Knobs, towel bars or supporter – all are compatible. Everything is well-matched and can be chosen freely.

Additionally we offer the right sealing profiles and splash guards for every situation. Any more questions? Contact us – we will be glad to advice you!



accessories – door handle

article no.	finish	glass thickness	article name	pu/pieces
8299MS7	bright chrome finish	6-12 mm	glass door handle	1/1
8299MS10	matt chrome finish		one sided	
8299MSPVD22	stainless steel finish*			

article no.	finish	glass thickness	article name	pu/pieces
8298MS7	bright chrome finish	6-12 mm	glass door handle	1/1
8298MS10	matt chrome finish		double sided	
8298SPVD22	stainless steel finish*			

article no.	finish	glass thickness	article name	pu/pieces
8293MS7	bright chrome finish	6-12 mm	glass door handle	1/1
8293MS10	matt chrome finish		one sided, with rubber stop	
8293MSPVD22	stainless steel finish*			

article no.	finish	glass thickness	article name	pu/pieces
8294MS7	bright chrome finish	6-12 mm	glass door handle	1/1
8294MS10	matt chrome finish		double sided, with rubber stop	
8294MSPVD22	stainless steel finish*			

article no.	finish	glass thickness	article name	pu/pieces
8502VA	stainless steel	6-8 mm	glass door knob	1/1
			single sided	

article no.	finish	glass thickness	article name	pu/pieces
8288MS7	bright chrome finish	6-12 mm	glass door knob	1/10
			double sided	

*PVD-Coated

accessories – door handle



*for 8 mm glass



8278MS



8278MS-A

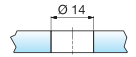
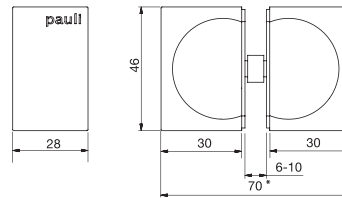

article no.	finish	glass thickness	article name	pu/pieces
8278MS7	bright chrome finish	6-10 mm	glass door handle	1/1
8278MS10	matt chrome finish		double sided	
8278MSPVD22	stainless steel finish*			

article no.	finish	glass thickness	article name	pu/pieces
8278MS7-A	bright chrome finish	6-10 mm	glass door handle	1/1
8278MS10-A	matt chrome finish		double sided	
8278MSPVD22-A	stainless steel finish*		without logo	

*for 8 mm glass

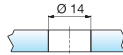
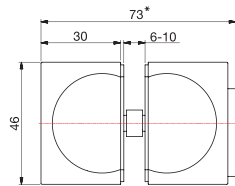
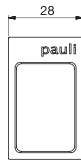

article no.	finish	glass thickness	article name	pu/pieces
8273MS7	bright chrome finish	6-10 mm	glass door handle	1/1
8273MS10	matt chrome finish		double sided with rubber stop	
8273MSPVD22	stainless steel finish*			

*for 8 mm glass

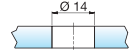
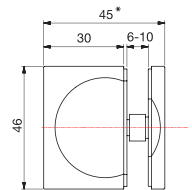
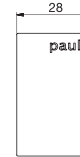

article no.	finish	glass thickness	article name	pu/pieces
8275MS7	bright chrome finish	6-10 mm	glass door handle	1/1
8275MS10	matt chrome finish		one sided	
8275MSPVD22	stainless steel finish*			

NEW

*for 8 mm glass

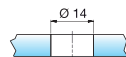
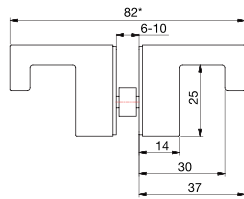
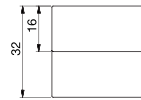

article no.	finish	glass thickness	article name	pu/pieces
8273MS7	bright chrome finish	6-10 mm	glass door handle	1/1
			double sided	

*PVD-Coated

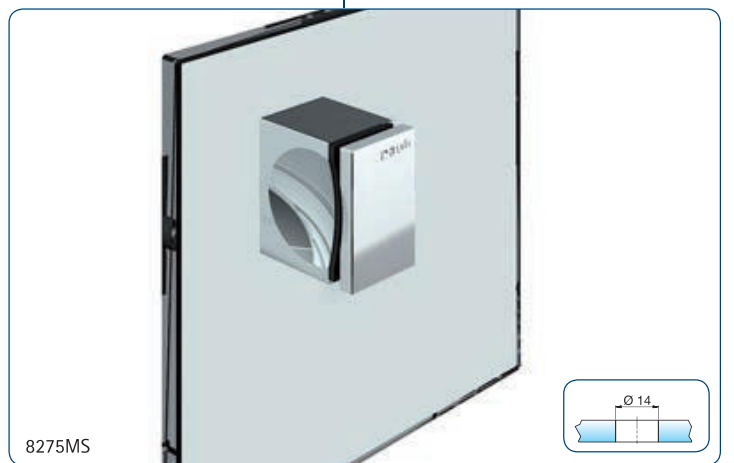
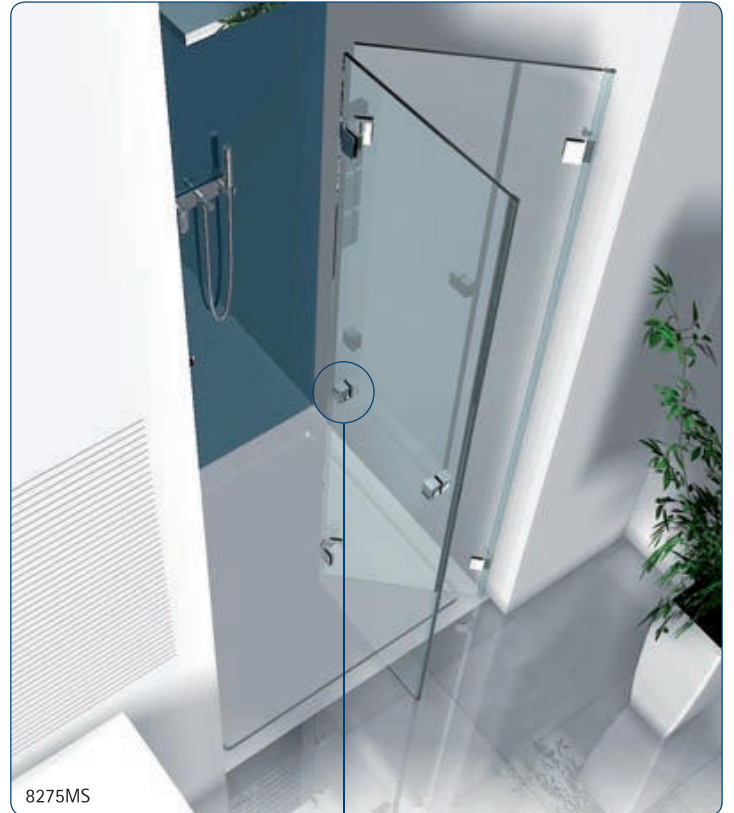

accessories – door handle



NEW

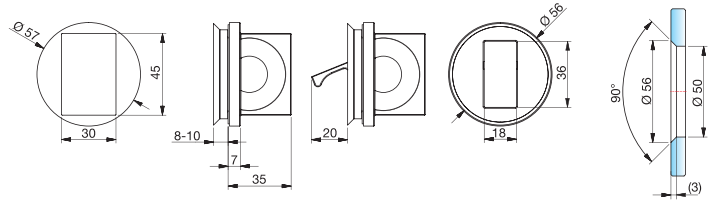

article no.	finish	glass thickness	article name	pu/pieces
8379MS7	bright chrome finish	8-10 mm	glass door handle	1/1
8379MS10	matt chrome finish		flush	
8379MSPVD22	stainless steel finish*			



Accessories





accessories – door handle



Nivello+ Set 10-210 mit 8379ZN

Accessories



accessories – door handle



article no.	finish	glass thickness	article name	pu/pieces
8276ZN5	bright chrome finish	6-10 mm	glass door handle	1/1
8276ZN1	matt chrome finish		single sided	
8276ZNPVD22	stainless steel finish*			

article no.	finish	glass thickness	article name	pu/pieces
8277ZN5	bright chrome finish	6-10 mm	glass door handle	1/1
8277ZN1	matt chrome finish		double sided	
8277ZNPVD22	stainless steel finish*			

article no.	finish	glass thickness	article name	pu/pieces
8277ZN5-A	bright chrome finish	6-10 mm	glass door handle	1/1
8277ZN1-A	matt chrome finish		double sided	
8277ZNPVD22-A	stainless steel finish*		without logo	

article no.	finish	glass thickness	article name	pu/pieces
8297MS7-50	bright chrome finish	6-12 mm	glass door handle	1/1
8297MS10-50	matt chrome finish		double sided	
8297MSPVD22-50	stainless steel finish*			

article no.	finish	glass thickness	article name	pu/pieces
8297MS7-300	bright chrome finish	6-12 mm	glass door handle	1/1
8297MS10-300	matt chrome finish		double sided	
8297MSPVD22-300	stainless steel finish*			

*PVD-Coated



Please indicate the length with all your orders! Other lengths are available on demand!



accessories - door handle

article no.	finish	glass thickness	article name	pu/pieces
8065VA-200	stainless steel	6-10 mm	door handle single sided	1/1
8065VA1-200	stainless steel polished		raised head, with handle piece	

article no.	finish	glass thickness	article name	pu/pieces
8066VA-200	stainless steel	8-10 mm	door handle single sided	1/1
8066VA1-200	stainless steel polished		flush, with handle piece	

article no.	finish	glass thickness	article name	pu/pieces
8061VA-200	stainless steel	6-10 mm	door handle single sided	1/1
8061VA1-200	stainless steel polished		raised head	

article no.	finish	glass thickness	article name	pu/pieces
8062VA-200	stainless steel	8-10 mm	door handle single sided	1/1
8062VA1-200	stainless steel polished		flush	

article no.	finish	glass thickness	article name	pu/pieces
8061VA-300	stainless steel	6-10 mm	door handle single sided	1/1
8061VA1-300	stainless steel polished		raised head	

article no.	finish	glass thickness	article name	pu/pieces
8062VA-300	stainless steel	8-10 mm	door handle single sided	1/1
8062VA1-300	stainless steel polished		flush	

Please indicate the length with all your orders! Other lengths are available on demand!



accessories – door handle



Technical drawing showing a side view of the handle with a length of 200 mm and a diameter of 16 mm. A detail view shows a 38 mm wide grip section with a 10 mm diameter hole. The mounting plate is 150 mm long with 10 mm diameter holes at each end.

article no.	finish	glass thickness	article name	pu/pieces
8060VA-200	stainless steel	6-10 mm	glass door handle	1/1
8060VA1-200	stainless steel polished		double sided	

Technical drawing showing a side view of the handle with a length of 300 mm and a diameter of 16 mm. A detail view shows a 38 mm wide grip section with a 10 mm diameter hole. The mounting plate is 200 mm long with 10 mm diameter holes at each end.

article no.	finish	glass thickness	article name	pu/pieces
8060VA-300	stainless steel	6-10 mm	glass door handle	1/1
8060VA1-300	stainless steel polished		double sided	



Please indicate the length with all your orders! Other lengths are available on demand!



length 1000 mm, cuttable to size

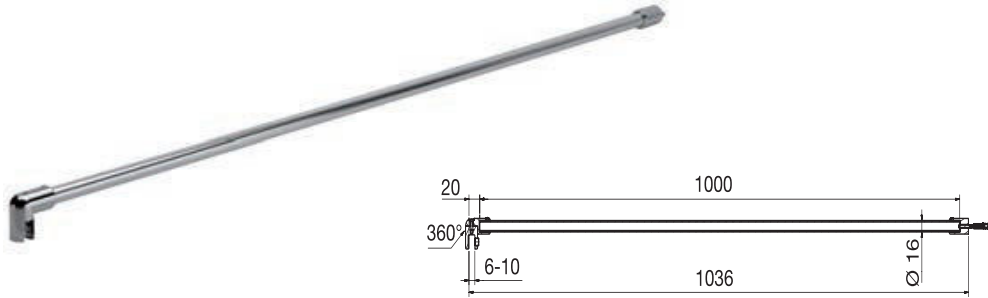

article no.	finish	glass thickness	article name	pu/pieces
8444MS7-1000	bright chrome finish	6-10 mm	supporter bar glass-wall	1/1



length 1000 mm, cuttable to size

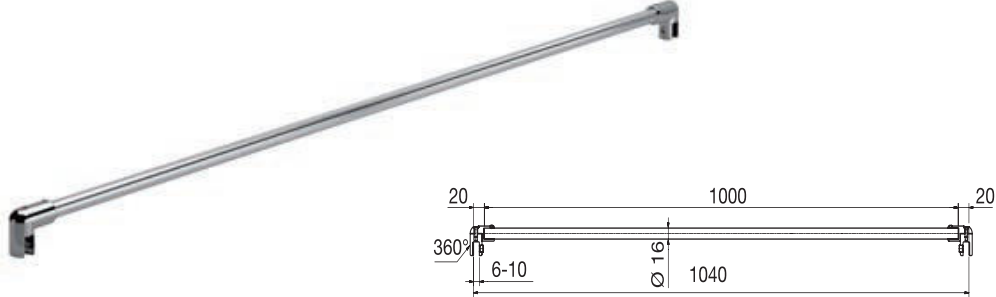

article no.	finish	glass thickness	article name	pu/pieces
8445MS7-1000	bright chrome finish	6-10 mm	supporter bar glass-glass	1/1



length 460 mm, cuttable to size

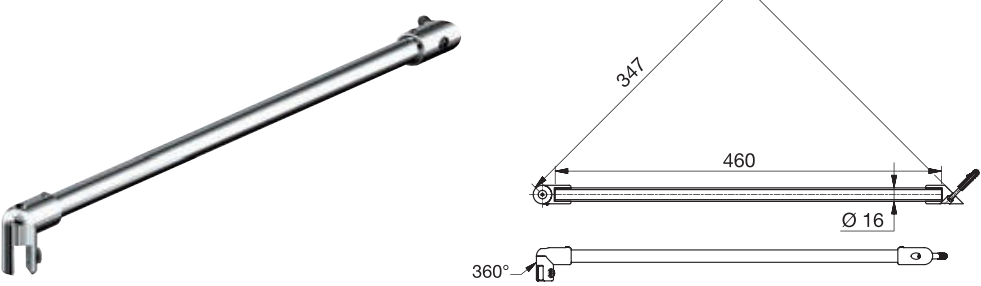

article no.	finish	glass thickness	article name	pu/pieces
8446MS7-460	bright chrome finish	6-10 mm	supporter bar glass-wall 45°	1/1



accessories – supporter bar

length 460 mm, cuttable to size

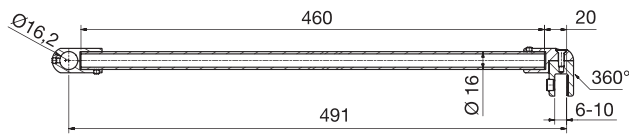

article no.	finish	glass thickness	article name	pu/pieces
8447MS7-460	bright chrome finish	6-10 mm	supporter bar glass-T-shaped adapter	1/1



length 1500 mm, cuttable to size fixation with through borehole at the glass

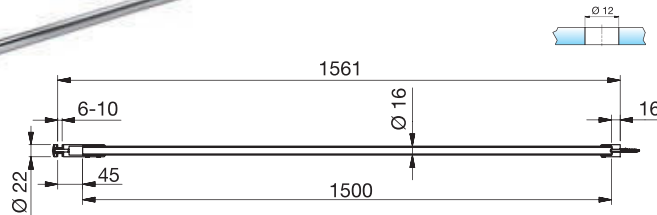
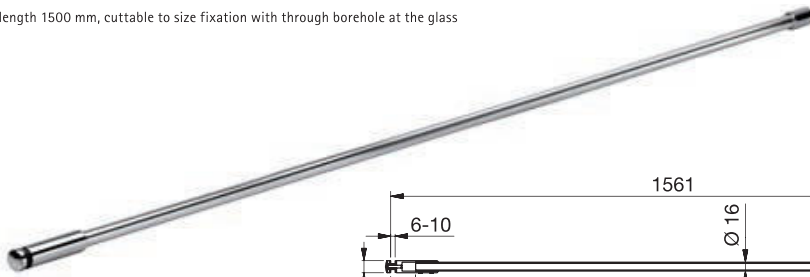

article no.	finish	glass thickness	article name	pu/pieces
8448MS7-1500	bright chrome finish	6-10 mm	supporter bar glass-wall	1/1



tube length cuttable to size

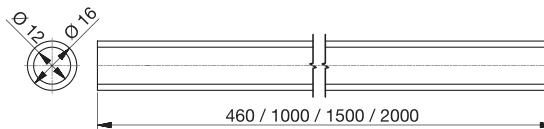

article no.	finish	length	article name	pu/pieces
8444-1E6EV5-460	see*	460 mm	supporter bar, tube	1/1
8444-1E6EV5-1000	art. no.	1000 mm	supporter bar, tube	1/1
8444-1E6EV5-1500	end	1500 mm	supporter bar, tube	1/1
8444-1E6EV5-2000		2000 mm	supporter bar, tube	1/1

*article no. end: E6/EV5=aluminium special etched anodised bright chrome finish

accessories – supporter bar

for tube Ø 16 mm

article no.	finish	glass thickness	article name	pu/pieces
8444MS7-W	bright chrome finish	-	wall adapter 90° for supporter bar	1/1

for tube Ø 16 mm

article no.	finish	glass thickness	article name	pu/pieces
8446MS7-W45	bright chrome finish	-	wall adapter 45° for supporter bar	1/1

for tube Ø 16 mm

article no.	finish	glass thickness	article name	pu/pieces
8447MS7-T	bright chrome finish	6-10 mm	T-adapter for supporter bar	1/1

for tube Ø 16 mm

article no.	finish	glass thickness	article name	pu/pieces
8444MS7-G	bright chrome finish	6-10 mm	glass adapter for supporter bar	1/1

Every adapter fits with 8444MS7, 8445MS7, 8446MS7, 8447MS7, 8448MS7, 8444-1E6EV5

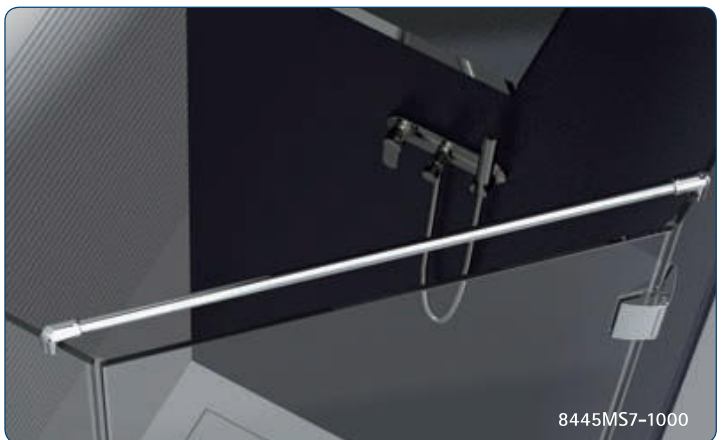
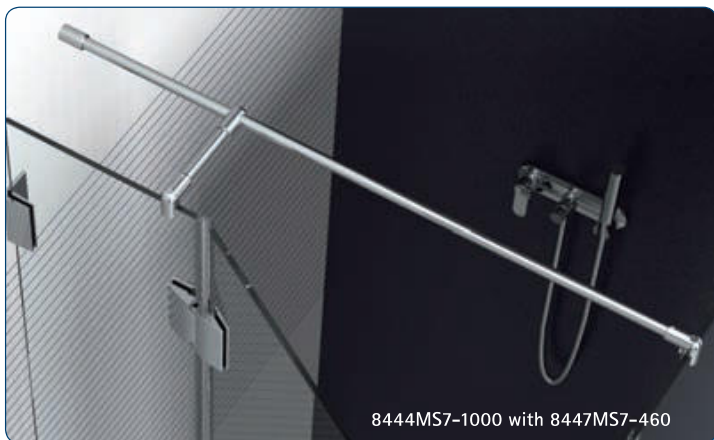

accessories – supporter bar

length 1000 mm, cuttable to size

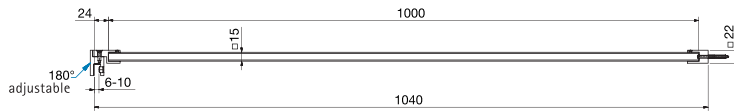
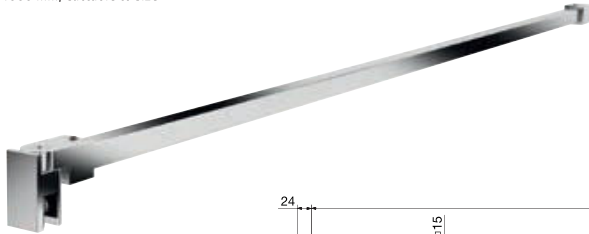

article no.	finish	glass thickness	article name	pu/pieces
8494MS7-1000	bright chrome finish	6-10 mm	supporter bar glass-wall	1/1

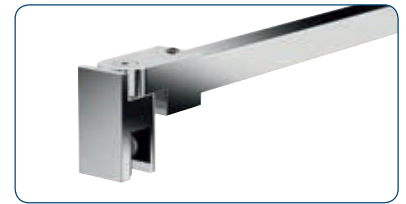

length 1000 mm, cuttable to size

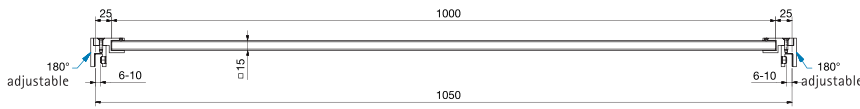

article no.	finish	glass thickness	article name	pu/pieces
8495MS7-1000	bright chrome finish	6-10 mm	supporter bar glass-glass	1/1

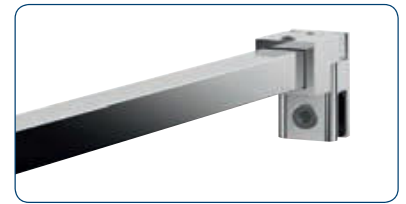

length 460 mm, cuttable to size

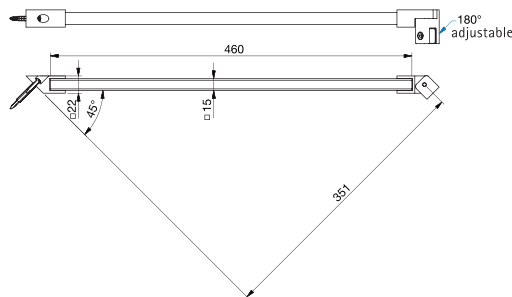

article no.	finish	glass thickness	article name	pu/pieces
8496MS7-460	bright chrome finish	6-10 mm	supporter bar glass-wall 45°	1/1



Attention: Delivery date on request!

accessories – supporter bar

length 460 mm, cuttable to size

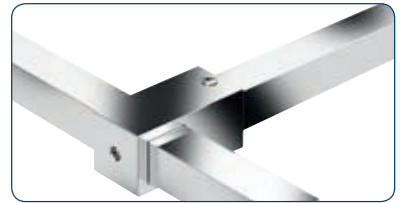
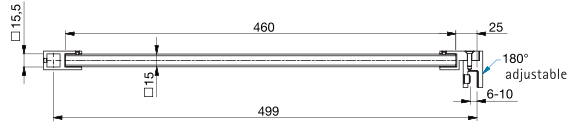

article no.	finish	glass thickness	article name	pu/pieces
8497MS7-460	bright chrome finish	6-10 mm	supporter bar glass-T-shaped adapter	1/1

length 1500 mm, cuttable to size fixation with through borehole at the glass

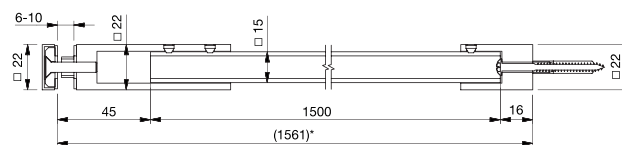

article no.	finish	glass thickness	article name	pu/pieces
8498MS7-1500	bright chrome finish	6-10 mm	supporter bar glass-wall	1/1

tube length cuttable to size

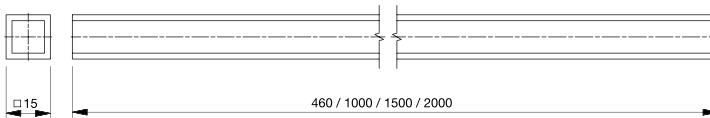
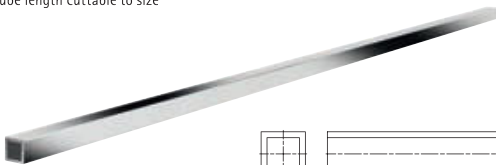

article no.	finish	length	article name	pu/pieces
8688-5E6EV5-460	see*	460 mm	supporter bar, tube	1/1
8688-5E6EV5-1000	art. no.	1000 mm	supporter bar, tube	1/1
8688-5E6EV5-1500	end	1500 mm	supporter bar, tube	1/1
8688-5E6EV5-2000		2000 mm	supporter bar, tube	1/1
8688-5MS7-1000	bright chrome finish	1000 mm	supporter bar, tube	1/1

*article no. end: E6/EV5=aluminium special etched anodised bright chrome finish

Attention: Delivery date on request!



accessories – supporter bar

for tube □ 15 mm

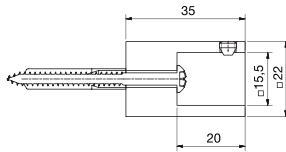

article no.	finish	glass thickness	article name	pu/pieces
8494MS7-W	bright chrome finish	-	wall adapter 90° for supporter bar	1/1

for tube □ 15 mm

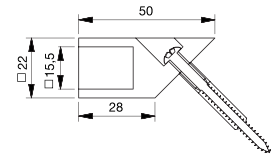

article no.	finish	glass thickness	article name	pu/pieces
8496MS7-W45	bright chrome finish	-	wall adapter 45° for supporter bar	1/1

for tube □ 15 mm

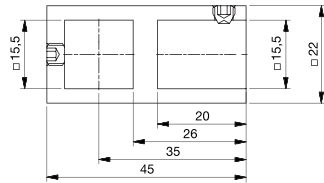

article no.	finish	glass thickness	article name	pu/pieces
8497MS7-T	bright chrome finish	6-10 mm	T-adapter for supporter bar	1/1

for tube □ 15 mm

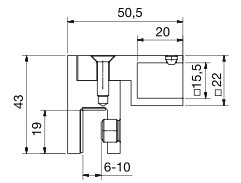

article no.	finish	glass thickness	article name	pu/pieces
8494MS7-G	bright chrome finish	6-10 mm	glass adapter for supporter bar	1/1

for tube □ 15 mm

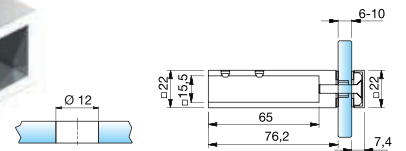

article no.	finish	glass thickness	article name	pu/pieces
8498MS7-G	bright chrome finish	6-10 mm	glass adapter for supporter bar	1/1

Attention: Delivery date on request!

Every adapter fits with 8494MS7, 8495MS7, 8496MS7, 8497MS7, 8498MS7, 8688-1E6EV5

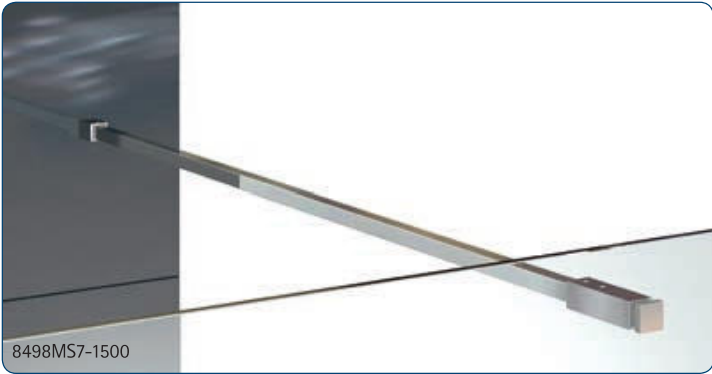
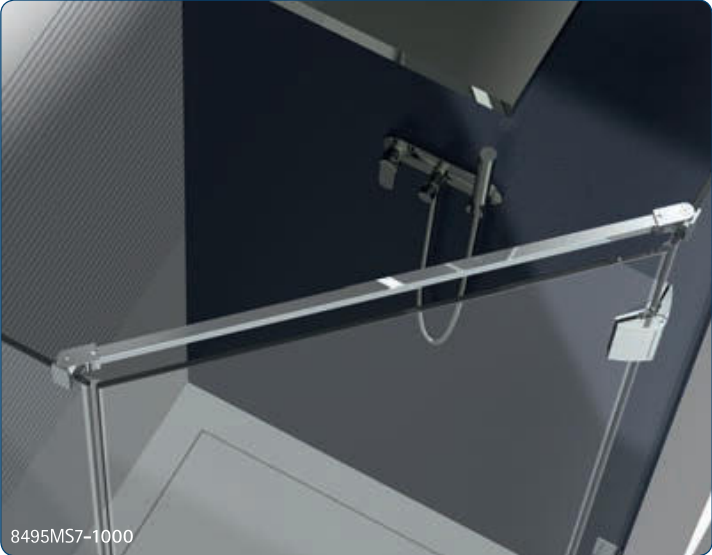

accessories – supporter bar

glass thickness: 8–10 mm
with adjustable wall bracket i.e. for sloping ceilings,
adjustability by right-handed / left-handed thread
within the tube

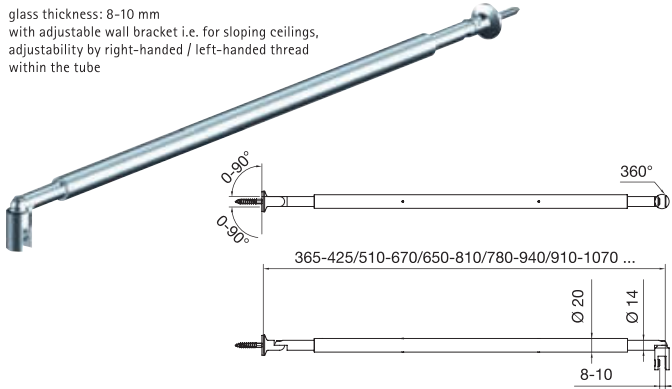

article no.	finish	article name	features	pu/pieces
8432MS_*-395	see "article -no.-end"	supporter bar glass-wall	adjustable from 365–425 mm	1/1
8432MS_*-590	see "article -no.-end"	supporter bar glass-wall	adjustable from 510–670 mm	1/1
8432MS_*-730	see "article -no.-end"	supporter bar glass-wall	adjustable from 650–810 mm	1/1
8432MS_*-860	see "article -no.-end"	supporter bar glass-wall	adjustable from 780–940 mm	1/1
8432MS_*-990	see "article -no.-end"	supporter bar glass-wall	adjustable from 910–1070 mm	1/1
8432MS_*-1050	see "article -no.-end"	supporter bar glass-wall	adjustable from 970–1130 mm**	1/1
8432MS_*-1190	see "article -no.-end"	supporter bar glass-wall	adjustable from 1110–1270 mm**	1/1
8432MS_*-1330	see "article -no.-end"	supporter bar glass-wall	adjustable from 1250–1410 mm**	1/1
8432MS_*-1460	see "article -no.-end"	supporter bar glass-wall	adjustable from 1380–1540 mm**	1/1
8432MS_*-1590	see "article -no.-end"	supporter bar glass-wall	adjustable from 1510–1670 mm**	1/1
8432MS_*-1720	see "article -no.-end"	supporter bar glass-wall	adjustable from 1640–1800 mm**	1/1
8432MS_*-1850	see "article -no.-end"	supporter bar glass-wall	adjustable from 1770–1930 mm**	1/1

other length upon request!

*article no. end: MSZ bright chrome finish; MS10 matt chrome finish; MSPVD22 stainless steel finish- PVD-coated
**Tube subdivided (visible parting line)

glass thickness: 8–10 mm
with adjustable wall bracket i.e. for sloping ceilings,
adjustability by right-handed / left-handed thread
within the tube

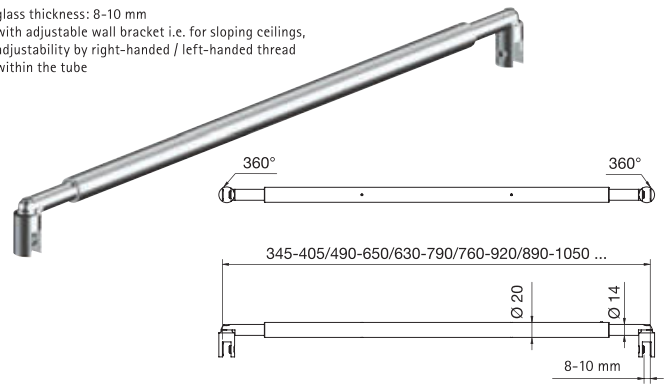

article no.	finish	article name	features	pu/pieces
8434MS_*-375	see "article -no.-end"	supporter bar glass-glass	adjustable from 345–405 mm	1/1
8434MS_*-570	see "article -no.-end"	supporter bar glass-glass	adjustable from 490–650 mm	1/1
8434MS_*-710	see "article -no.-end"	supporter bar glass-glass	adjustable from 630–790 mm	1/1
8434MS_*-840	see "article -no.-end"	supporter bar glass-glass	adjustable from 760–920 mm	1/1
8434MS_*-970	see "article -no.-end"	supporter bar glass-glass	adjustable from 890–1050 mm	1/1
8434MS_*-1030	see "article -no.-end"	supporter bar glass-glass	adjustable from 950–1110 mm**	1/1
8434MS_*-1170	see "article -no.-end"	supporter bar glass-glass	adjustable from 1090–1250 mm**	1/1
8434MS_*-1310	see "article -no.-end"	supporter bar glass-glass	adjustable from 1230–1390 mm**	1/1
8434MS_*-1440	see "article -no.-end"	supporter bar glass-glass	adjustable from 1360–1520 mm**	1/1
8434MS_*-1570	see "article -no.-end"	supporter bar glass-glass	adjustable from 1490–1650 mm**	1/1
8434MS_*-1700	see "article -no.-end"	supporter bar glass-glass	adjustable from 1620–1780 mm**	1/1
8434MS_*-1830	see "article -no.-end"	supporter bar glass-glass	adjustable from 1750–1910 mm**	1/1

other length upon request!



application sample for 8432MS



application sample for 8434MS

glass thickness: 8-10 mm

article no.	finish	article name	features	pu/pieces
8474MS_*-380	see "article -no.-end"	supporter bar glass-wall	adjustable from 300-460 mm	1/1
8474MS_*-510	see "article -no.-end"	supporter bar glass-wall	adjustable from 430-590 mm	1/1
8474MS_*-640	see "article -no.-end"	supporter bar glass-wall	adjustable from 560-720 mm	1/1
8474MS_*-770	see "article -no.-end"	supporter bar glass-wall	adjustable from 690-850 mm	1/1
8474MS_*-900	see "article -no.-end"	supporter bar glass-wall	adjustable from 820-980 mm	1/1
8474MS_*-1030	see "article -no.-end"	supporter bar glass-wall	adjustable from 950-1110 mm	1/1
8474MS_*-1160	see "article -no.-end"	supporter bar glass-wall	adjustable from 1080-1240 mm	1/1

other length upon request!

*article no. end: MS2 bright chrome finish; MS10 matt chrome finish; MSPVD22 stainless steel finish- PVD-coated

glass thickness: 8-10 mm

Art.-Nr.	Oberfläche	Artikelbezeichnung	Merkmale	VE/Stück
8475MS_*-370	siehe Art.-Nr.-Endung*	Stabilisationsstange Glas-Glas	von 290-450 mm verstellbar	1/1
8475MS_*-500	siehe Art.-Nr.-Endung*	Stabilisationsstange Glas-Glas	von 420-580 mm verstellbar	1/1
8475MS_*-630	siehe Art.-Nr.-Endung*	Stabilisationsstange Glas-Glas	von 550-710 mm verstellbar	1/1
8475MS_*-760	siehe Art.-Nr.-Endung*	Stabilisationsstange Glas-Glas	von 680-840 mm verstellbar	1/1
8475MS_*-890	siehe Art.-Nr.-Endung*	Stabilisationsstange Glas-Glas	von 810-970 mm verstellbar	1/1
8475MS_*-1020	siehe Art.-Nr.-Endung*	Stabilisationsstange Glas-Glas	von 940-1100 mm verstellbar	1/1
8475MS_*-1150	siehe Art.-Nr.-Endung*	Stabilisationsstange Glas-Glas	von 1070-1230 mm verstellbar	1/1

other length upon request!



accessories – supporter bar

glass thickness: 8-10 mm

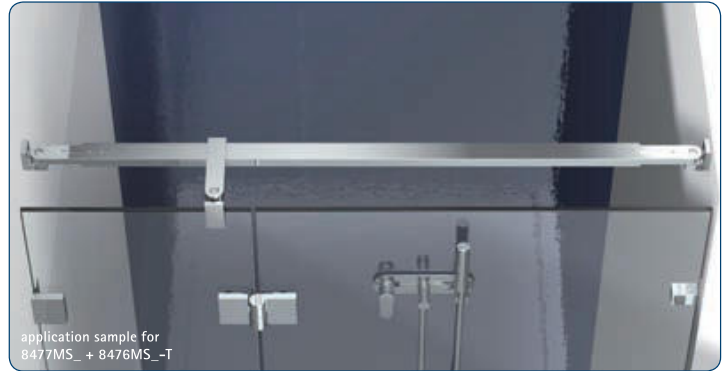
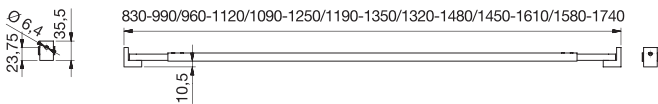
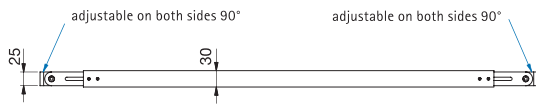

article no.	finish	article name	features	pu/pieces
8477MS_*-910	see "article -no.-end"	supporter bar wall-wall-glass	adjustable from 830-990 mm	1/1
8477MS_*-1040	see "article -no.-end"	supporter bar wall-wall-glass	adjustable from 960-1120 mm	1/1
8477MS_*-1170	see "article -no.-end"	supporter bar wall-wall-glass	adjustable from 1090-1250 mm	1/1
8477MS_*-1270	see "article -no.-end"	supporter bar wall-wall-glass	adjustable from 1190-1350 mm	1/1
8477MS_*-1400	see "article -no.-end"	supporter bar wall-wall-glass	adjustable from 1320-1480 mm	1/1
8477MS_*-1530	see "article -no.-end"	supporter bar wall-wall-glass	adjustable from 1450-1610 mm	1/1
8477MS_*-1660	see "article -no.-end"	supporter bar wall-wall-glass	adjustable from 1580-1740 mm	1/1

other length upon request!

*article no. end: MS7 bright chrome finish; MS10 matt chrome finish; MSPVD22 stainless steel finish- PVD-coated

article no.	finish	glass thickness	article name	pu/pieces
8473MS7	bright chrome finish	6-10 mm	glass plate support	1/1
8473MS10	matt chrome finish		for 8474MS, 8475MS	
8473MSPVD22	stainless steel finish*		and 8477MS	



article no.	finish	glass thickness	article name	pu/pieces
8476MS7-T	bright chrome finish	6-10 mm	T-adapter for	1/1
8476MS10-T	matt chrome finish		8474MS, 8475MS	
8476MSPVD22-T	stainless steel finish*		and 8477MS	



*PVD-Coated

accessories – striker bracket



to put on glass edge
no glass processing

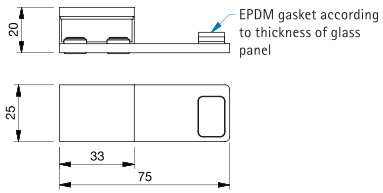



EPDM gasket according to thickness of glass panel

article no.	finish	glass thicken.	article name	pu/pieces
8490MS7-L	bright chrome finish	6-10 mm	striker bracket version left (door stop)	1/1

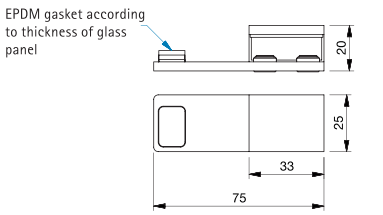

to put on glass edge
no glass processing

EPDM gasket according to thickness of glass panel

article no.	finish	glass thicken.	article name	pu/pieces
8490MS7-R	bright chrome finish	6-10 mm	striker bracket version right (door stop)	1/1

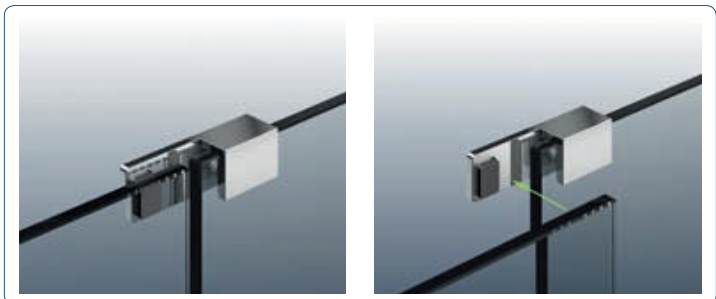

Attention: Delivery date on request!



EPDM gasket according to thickness of glass panel

article no.	finish	glass thickn.	article name	pu/pieces
8491MS7	bright chrome finish	6-10 mm	T-adapter striker bracket for 8474MS, 8475MS and 8477MS (door stop)	1/1

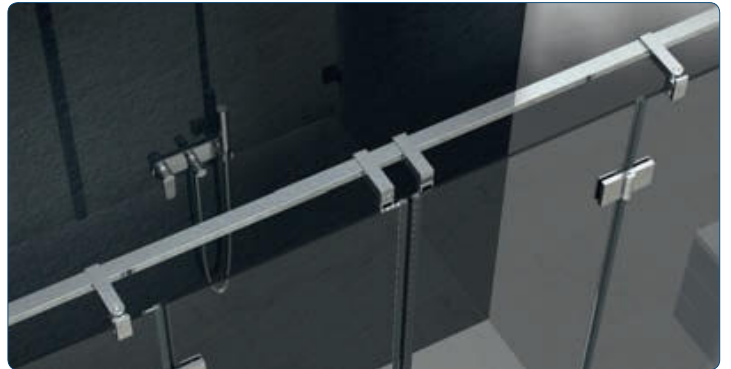

pluggable onto the glass edge, no glass processing necessary

article no.	finish	glass thickness	article name	pu/pieces
8499MS7	bright chrome finish	6-10 mm	door stop buffer striker bracket	1/1

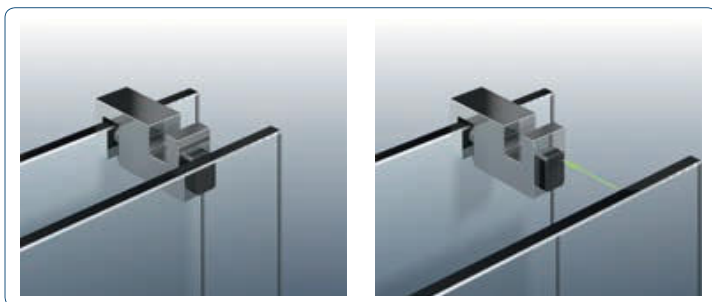

Attention: Delivery date on request!

accessories – towel bar

with glass mount and wall mount
(raised head or flush) length (1000/1500 mm) cuttable to size

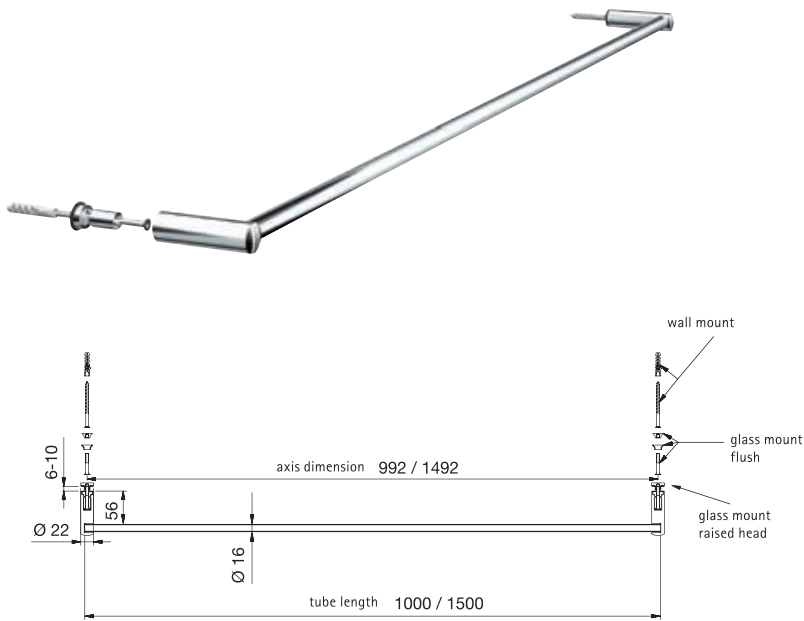

wall mount

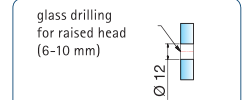
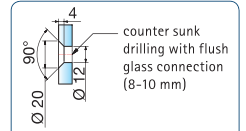
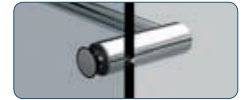

article no.	finish	glass thickness	article name	pu/pieces
8686MS7-1000	bright chrome finish	6-10 mm	towel bar	1/1
8686MS7-1500				

length variable up to 1000 mm
please include axis dimension in the order
longer length upon request.

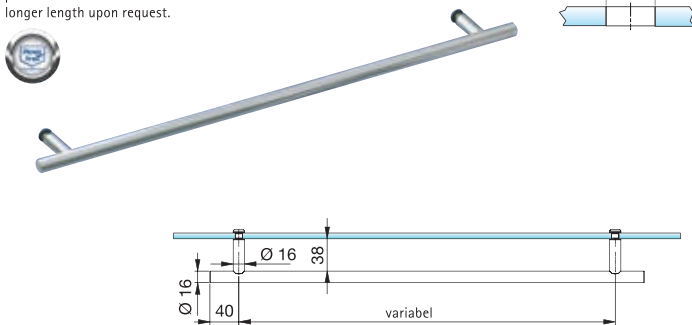

article no.	finish	glass thickness	article name	pu/pieces
8063VA-V	stainless steel	6-10 mm	towel bar for glass	1/1
8063VA1-V	stainless steel polished		raised head	

with glass mount and knob
length (1000 mm) cuttable to size

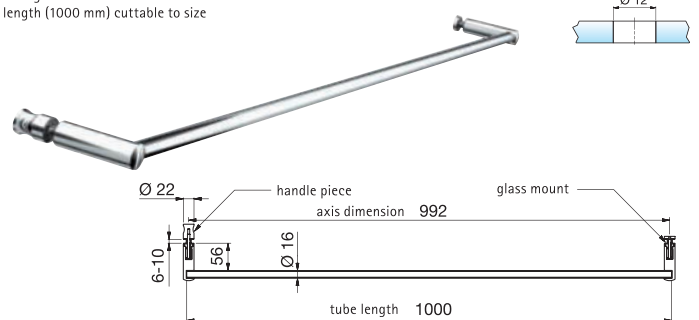

article no.	finish	glass thickness	article name	pu/pieces
8687MS7-1000	bright chrome finish	6-10 mm	towel bar for glass	1/1

with glass mount and wall mount
(raised head or flush) length (1000/1500 mm) cuttable to size

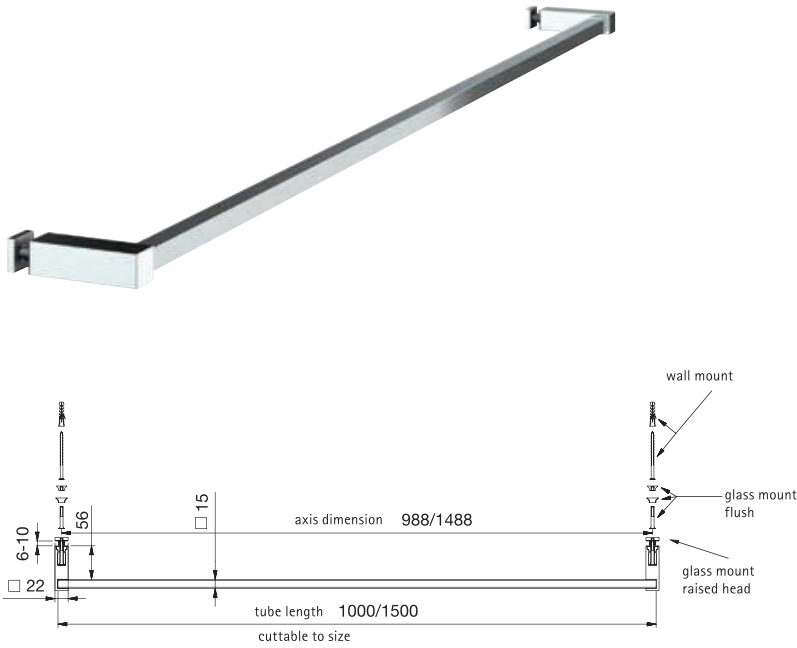

wall mount

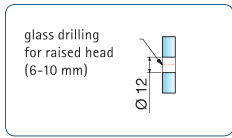
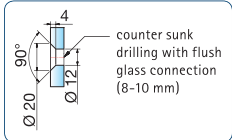

article no.	finish	glass thickness	article name	pu/pieces
8688MS7-1000	bright chrome finish	6-10 mm	towel bar	1/1
8688MS7-1500				

with glass mount and knob
length (1000 mm) cuttable to size

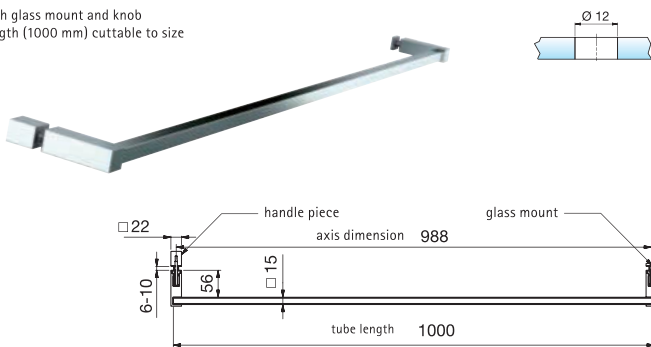

article no.	finish	glass thickness	article name	pu/pieces
8689MS7-1000	bright chrome finish	6-10 mm	towel bar	1/1

pluggable onto the glass edge, no glass processing necessary

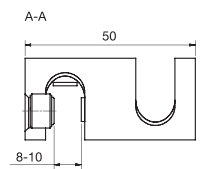
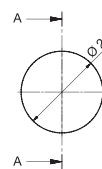

article no.	finish	glass thickness	article name	pu/pieces
8696MS7	bright chrome finish	8-10 mm	towel bar	1/1
8696MS10	matt chrome finish			
8696MSPVD22	stainless steel finish*			

accessories – profiles



single clamping jaws moveable on complete profile length
2010 mm = 5 clamping jaws, 2500 mm = 6 clamping jaws

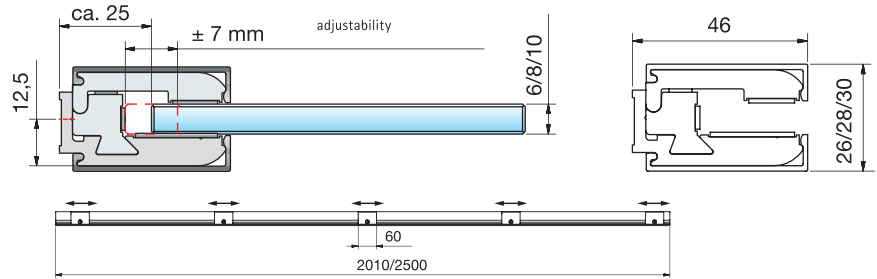

endcaps per 2 pieces (see chart on the right) are included in set!

article no.	finish	glass thickness	article name	pu/pieces
8884_*-2010	see "article	6/8/10 mm	clamp profile	1/1
8884_*-2500	-no.-end"			

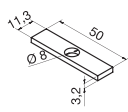
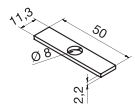

Intermediate layers for 8884 to remove any unevenness in the wall, 5 pieces per thickness are supplied with the set. Unevenness can be removed from 2 mm in 1-mm stages through combining and/or doubling.

accessories-article no.	material	article name
8885HZ	Hartzellmaterial	Zwischenanlage zu 8884



*article no. end: **E6EV1** =aluminium special etched anodised natural colour; **E6EV5**=aluminium special etched anodised bright chrome finish; **E1/23** =aluminium ground anodised nickel silver (stainless steel finish)



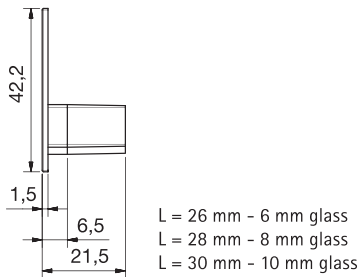
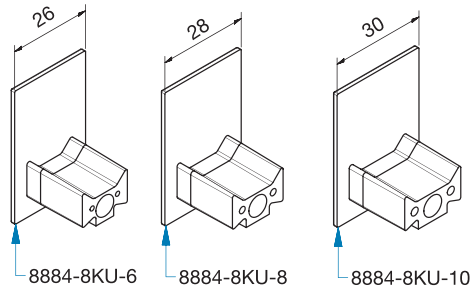

article no.	finish	glass thickness	article name	pu/pieces
8884-8KU_*-6	see "article	6 mm	end cap for clamping	1/1
8884-8KU_*-8	-no.-end"	8 mm	profile 8884, closed	
8884-8KU_*-10		10 mm		

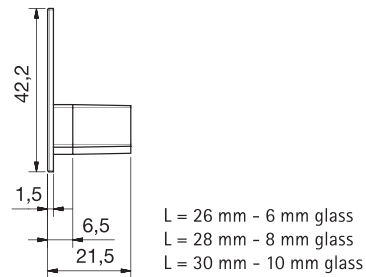
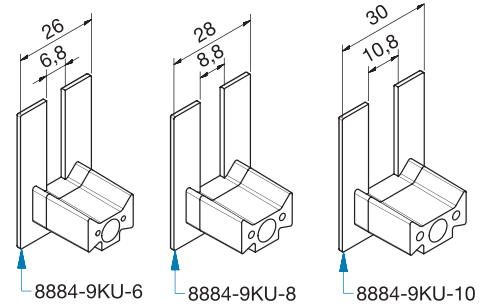

article no.	finish	glass thickness	article name	pu/pieces
8884-9KU_*-6	see "article	6 mm	end cap for clamping	1/1
8884-9KU_*-8	-no.-end"	8 mm	profile 8884, notched	
8884-9KU_*-10		10 mm		

suitable for wetroom

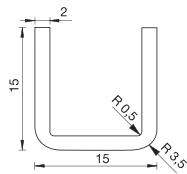

article no.	finish	plate thickness	article name	pu/pieces
5015VA1	stainless steel polished	≤ 10 mm	U-profile	1/1
5015VA2	stainless steel		15x15x5.000x2 mm	

suitable for wetroom

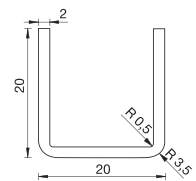

article no.	finish	plate thickness	article name	pu/pieces
5020VA1	stainless steel polished	≤ 15 mm	U-profile	1/1
5020VA2	stainless steel		20x20x5.000x2 mm	

*article no. end: KU6 =plastic matt chrome finish; KU7=plastic bright chrome finish;
KU22 =plastic stainless steel finish

accessories – sample case, display



article no.	article name	pu/pieces
C21	sample case content: Farfalla, Pontere, Papillon, Pillango, accessories	1/1



article no.	article name	pu/pieces
C29	sample case content: Flamea, Flinter, Fluture, accessories	1/1

C41 - Flinter



article no.	article name	pu/pieces
C40	display for product samples Flamea	1/1
C41	display for product samples Flinter	1/1
C42	display for product samples Fluture	1/1
C43	display for product samples Pontere	1/1
C44	display for product samples Farfalla	1/1
C45	display for product samples Pillango	1/1
C46	display for product samples Papillon	1/1
C47	display for product samples Vivere II	1/1



article no.	article name	pu/pieces
C38	sample case content: Nivello, Nivello* Zubehör	1/1



with glass mount and wall mount

article no.	finish	glass thickness	article name	pu/pieces
8274MS7-L	bright chrome finish	6-10 mm	door stop, left	1/1
8274MS10-L	matt chrome finish		glass/wall, left	
8274MSPVD22-L	stainless steel finish*			

with glass mount and wall mount

article no.	finish	glass thickness	article name	pu/pieces
8274MS7-R	bright chrome finish	6-10 mm	door stop, right	1/1
8274MS10-R	matt chrome finish		glass/wall, right	
8274MSPVD22-R	stainless steel finish*			

NEW

article no.	finish	glass thickness	article name	pu/pieces
8274MS7-D	bright chrome finish	6-10 mm	door stop, double-sided version	1/1
8274MS10-D	matt chrome finish		glass/glass,	
8274MSPVD22-D	stainless steel finish*		double-sided version	

article no.	finish	glass thickness	article name	pu/pieces
8440MS7	bright chrome finish	-	door stop, glass-wall	1/1
8440MS10	matt chrome finish			
8440MSPVD22	stainless steel finish*			

*PVD-Coated

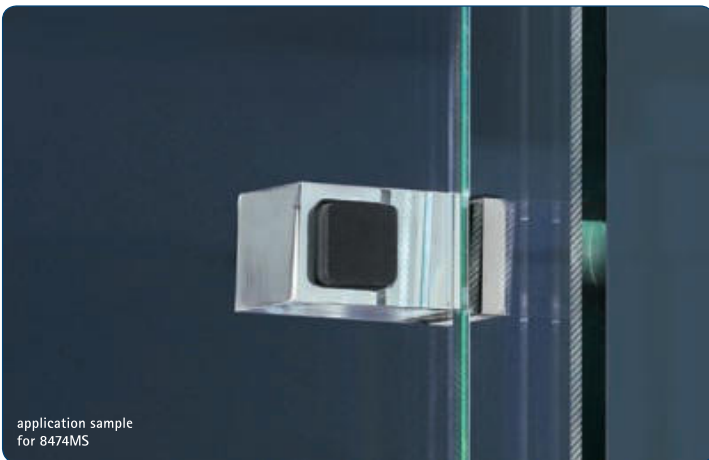

accessories – miscellaneous



article no.	article name	pu/pieces
Z061	scissors for sealing profiles	1/1

for shower door hinge Pillango



article no.	article name	pu/pieces
8479ST8	allen wrench angular 4 mm	1/1

for adjustment of the Vivere extender wheel



article no.	article name	pu/pieces
Z058	adjustable face spanner Ø 3 mm	1/1

for installation of point-fixed, e.g. for 7772VA

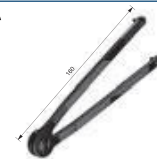

article no.	article name	pu/pieces
Z059	adjustable face spanner Ø 2,5 mm	1/1

combined in one bag; each 100 x 80 mm

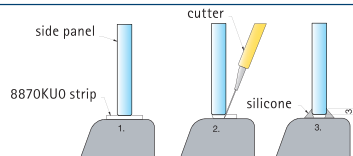
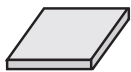

article no.	article name	pu/pieces
8870KU0	each 2 plates of soft PVC in 2 and 3 mm thickness	1/1

glass thickness: 6-10 mm

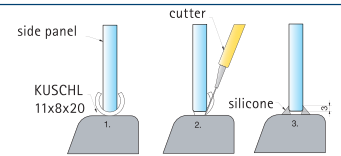

article no.	article name	pu/pieces
KUSCHL11X8X20	plastic tubing (1,5 mm) for security glass edges	1/1

zusammen in einem Polybeutel; je 70 x 90 mm

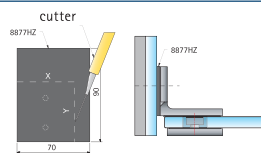
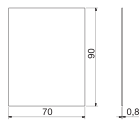

Art.-Nr.	Artikelbezeichnung	VE/Stück
8877HZ	für die Montage von Beschlägen an Glaswänden	1/1



article no.	article name	pu/pieces
Z092VA	spax screw, counter sunk, TX25 drive 6x60 A2	1/1
Z092VA5		
Z092VA6		

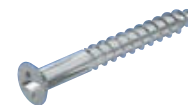

article no.	article name	pu/pieces
7083-1VA	countersunk wood screw recessed 6 x 50 mm	1/1
S7997A2D5X60	countersunk wood screw recessed 5 x 60 mm	1/1

VA5 = stainless steel bright chrome finish VA6 = stainless steel matt chrome finish



article no.	article name	pu/pieces
8000ST8	torque wrench with setting scale – automatic triggering	1/1

Accuracy: ± 3 % of indicated

Version: Robust torque wrench, adjustable with micrometer scale, with protection against accidental changes to the setting. Integral ratchet to accept sockets. Size 20 – with reversible ratchet and fixed square drive pin – only for right-hand tightening.

Function: On reaching the set torque value the wrench triggers "indicating" (audibly and perceptible) and is then again immediately ready for use.

Application: For controlled tightening of screws to pre-set torque.

8000ST8, torque wrench with setting scale		
size = maximum torque	Nm	20
Tightening value (scale range)	Nm	4-20
Scale graduation, 1 graduation =	Nm	0,1
Overall length	mm	230
Weight	kg	0,4
Square drive inch	inch	1/4"

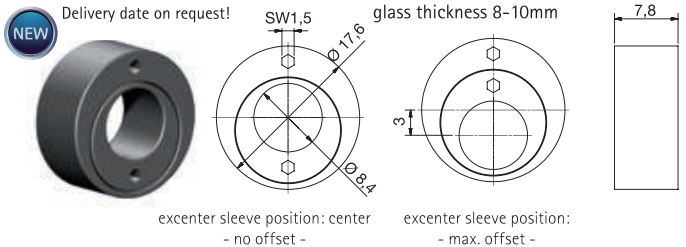

Delivery date on request!
Position of excenter sleeve can be freely selected, adjustment by a hexagon socket wrench SW1.5mm Article contains 50 pieces

article no.	article name	pu/pieces
8121KU	double excenter sleeve for shower door hinge Farfalla, Pillango and Papillon, as well as for all fixations with glass drilling Ø 18mm and stud Ø 8,2mm	1/1

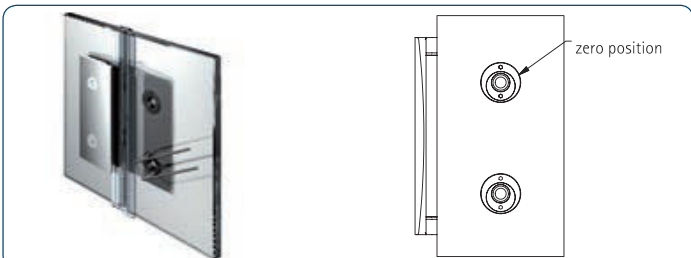

The double excenter sleeves permit a better centering and fixation of the shower door hinge in the glass drilling.

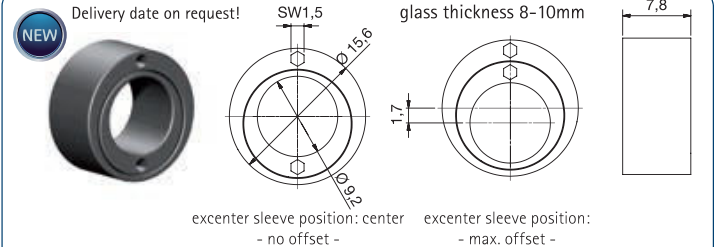

Delivery date on request!
Angle can be freely selected, adjustment by a hexagon socket wrench SW1.5mm Article contains 50 pieces

article no.	article name	pu/pieces
8149KU	double excenter sleeve for shower door hinge Flinter, as well as for all fixations with glass drilling Ø 16mm and stud Ø 9mm	1/1

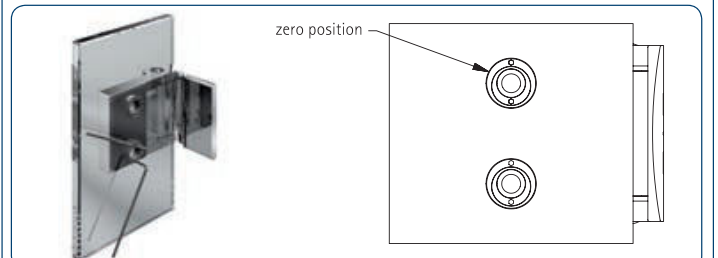

The double excenter sleeves permit a better centering and fixation of the shower door hinge in the glass drilling.

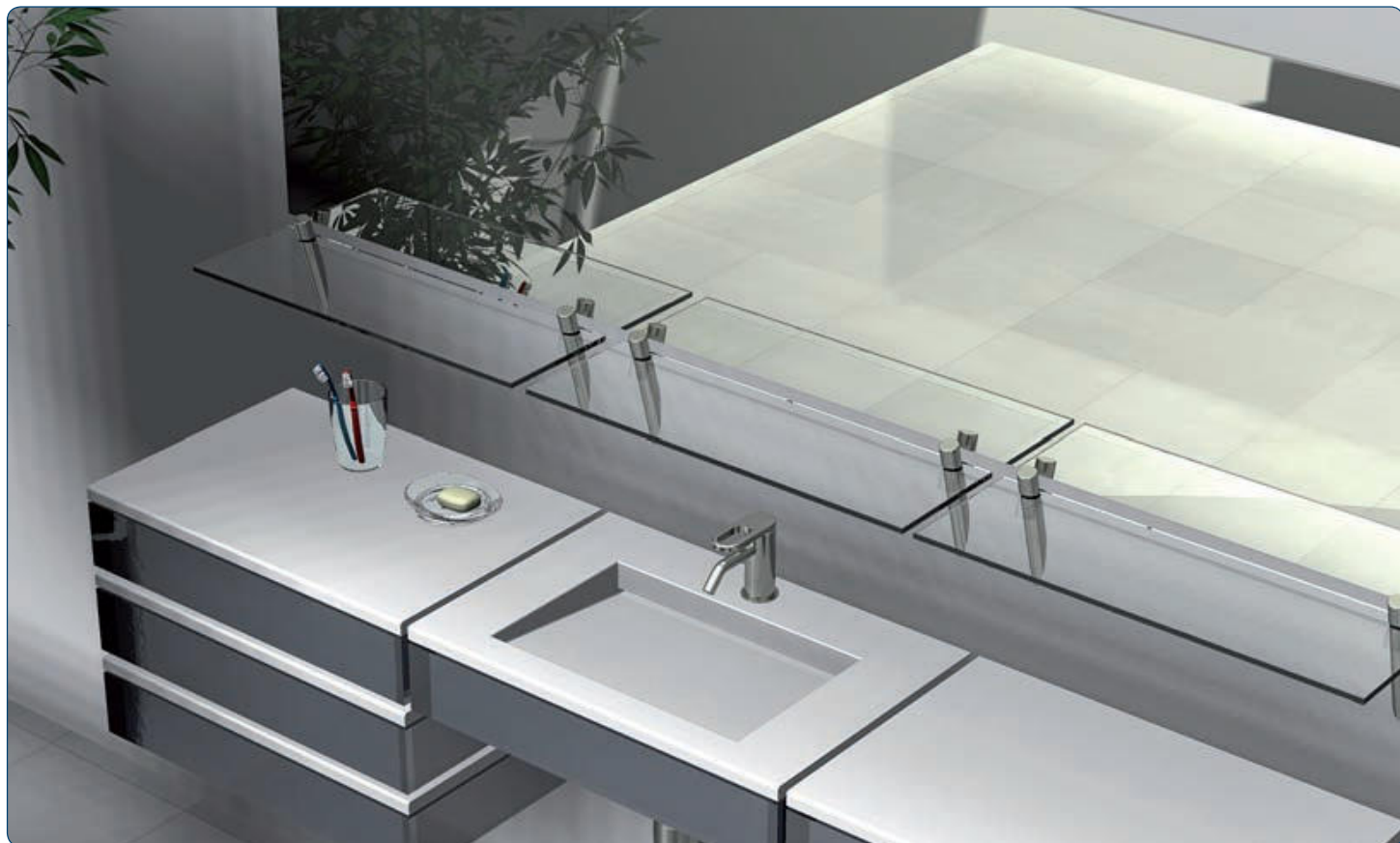

Even a small collection takes a giant show

Maintaining the transparent character of glass takes discreet binders. They are based on the easy and at the same sophisticated principle of form and function, get the bathroom going and can be used as shelf or a place to put something.



glass plate support

article no.	finish	glas thckn.	article name	pu/pieces
10000ZN5	bright chrome finish	6-12 mm	glass plate support,	1/2
10000ZN1	matt chrome finish		2 fixation drillings Ø 6 mm	
10000RAL	RAL-colours			

load capacity				
max. a	e	e	e	
300 mm	100 mm	200 mm	300 mm	 6 mm
	7,5 kg	3,8 kg	2,5 kg	

article no.	finish	glas thckn.	article name	pu/pieces
10020ZN5	bright chrome finish	6-10 mm	glass plate support,	1/20
10020ZN1	matt chrome finish		2 fixation drillings Ø 4,5mm	
10020RAL	RAL-colours			

load capacity				
max. a	e	e	e	
500	100 mm	200 mm	300 mm	 6 mm
	37,5 kg	18,7 kg	12,5 kg	

Elaborations on the maximum load capacity can be found on page 133.

safety glass (ESG) transparent

article no.	article name	bore hole
1100001GLAS	glass 398x195x6 mm	not drilled
1100011GLAS	glass 398x195x6 mm	drilled
	(for glass plate support 10000 only)	Ø 10 mm

article no.	article name	bore hole
1100030GLAS	glass 800x195x6 mm	not drilled
1100033GLAS	glass 800x195x6 mm	drilled
	(for glass plate support 10000 only)	Ø 10 mm

article no.	article name	bore hole
1100050GLAS	glass 800x195x6 mm	not drilled
1100055GLAS	glass 800x195x6 mm	drilled
	(for glass plate support 10000 only)	Ø 10 mm

glass plate support

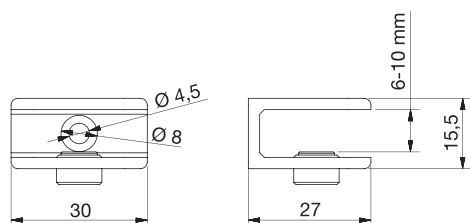

article no.	finish	glas thickn.	article name	pu/pieces
2880ZN5	bright chrome finish	6-10 mm	glass plate support,	1/20
2880ZN1	matt chrome finish		1 fixation drilling Ø 4,5 mm	
2880RAL	RAL-colours			

load capacity

max. a	e	e	e	
300	100 mm	200 mm	300 mm	 6 mm
	7,5 kg	3,75 kg	2,5 kg	

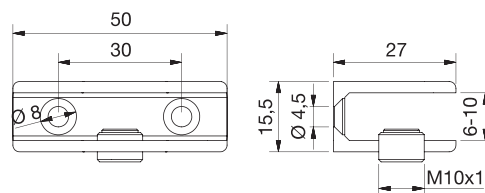

article no.	finish	glas thickn.	article name	pu/pieces
2884ZN5	bright chrome finish	6-10 mm	glass plate support,	1/20
2884ZN1	matt chrome finish		2 fixation drillings Ø 4,5 mm	
2884RAL	RAL-colours			

load capacity

max. a	e	e	e	
300	100 mm	200 mm	300 mm	 6 mm
	7,5 kg	3,75 kg	2,5 kg	

Elaborations on the maximum load capacity can be found on page 133.





article no.	finish	glas thckn.	article name	pu/pieces
2877ZN5	bright chrome finish	6-10 mm	glass plate support,	1/20
2877ZN1	matt chrome finish		1 fixation drilling Ø 6 mm	
2877RAL	RAL-colours			

load capacity
with 4 pieces 0,2 m²

8 kg

6 mm

article no.	finish	glas thckn.	article name	pu/pieces
2881ZN5	bright chrome finish	6-10 mm	glass plate support,	1/20
2881ZN1	matt chrome finish		2 fixation drillings Ø 4,5 mm	
2881RAL	RAL-colours			

load capacity

max. a	e	e	e	
500 mm	100 mm	200 mm	300 mm	
	30 kg	15 kg	10 kg	6 mm

It is recommended to refer to the maximum load capacity. Point of breaking is significantly higher than recommended. Extending the shelves is completely unproblematic. Please note the maximum measurement max. a.

accessories – glass panel

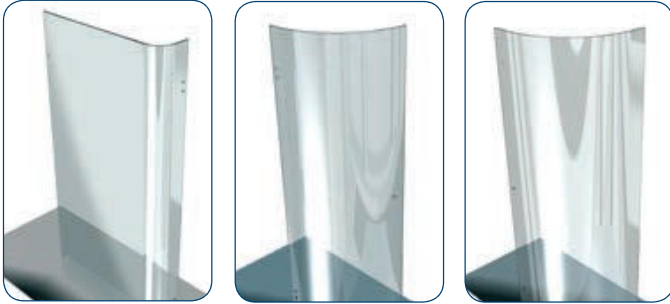

remarks for all bended glass:

tolerance:

- dimension tolerances = ± 2 mm per running meter
- backfill (twisting) = max. ± 3 mm per running meter
- height of edge deflection = max. ± 3 mm per running meter
- deviation from contour exactness = max. ± 3 mm per running meter
- bulges in edge developing zone are possible

aelotropy:

Aelotropy occurs during thermal loading process of glass. Different voltage zones lead to the compound fraction of the light beam. Only the polarized parts of the day light make through spectral coloured annuli, cloud images and similar this appearance visible. These appearances are due to production process and therefore not a reason for rejection.



glass processing:
tempered safety glass 8 mm, clear with 2 bores \varnothing 20 mm,
4 bores \varnothing 18 mm
all edges ground and polished



article no.	article name	pu/pieces
8141-1GLAS-R98	side panel for Farfalla with glass bores for shower door hinge glass-glass 180° h 2000 x w 235 x d 882 mm	1/1

glass processing:
tempered safety glass 8 mm, clear with 2 bores \varnothing 20 mm,
4 bores \varnothing 18 mm
all edges ground and polished



article no.	article name	pu/pieces
8142-1GLAS-R98	side panel for Pillango + Papillon with glass bores for shower door hinge glass-glass 180° h 2000 x w 235 x d 882 mm	1/1



type 214



type 407



type 214



type 407

Additional and detailed information about curved glasses you will find in our technical catalogue accessories



8570VA R500

glasset for 8570VA R500

glass processing:
tempered safety glass 8 mm, all edges ground and polished



article no.	1 set consists of
8581GLAS-R500-900	2 x side panel 2 x wing of door R500



8571VA R520

glasset for 8571VA R520

glass processing:
tempered safety glass 8 mm, all edges ground and polished



article no.	1 set consists of
8581GLAS-R520-1000	2 x side panel 2 x wing of door R520



8572VA R550

glasset for 8572VA R550

glass processing:
tempered safety glass 8 mm, all edges ground and polished



article no.	1 set consists of
8581GLAS-R550-1000	2 x side panel 2 x wing of door R550

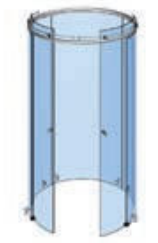

8522VA

glasset for 8522VA

glass processing:
tempered safety glass 8 mm, all edges ground and polished



article no.	1 set consists of
1 x 8525-1GLAS-R515	3 x side panel
1 x 8525-2GLAS-R515	2 x wing of door R515
3 x 8525-3GLAS-R540	

accessories – glass panel



glass processing:
tempered safety glass 6 mm, clear: 1 bore ø 14 mm;
4 bores ø 18 mm
all edges ground and polished



article no.	article name	pu/pieces
8144GLAS-R500	bended door leaf for Farfalla, Papillon and Pillango h 2000 mm, R500	1/1
8143GLAS-R550	bended door leaf for Farfalla, Papillon and Pillango h 2000 mm, R550	1/1

glass processing:
tempered safety glass 6 mm, clear: 1 bore ø 14 mm;
4 bores ø 18 mm
all edges ground and polished



article no.	article name	pu/pieces
8147-1GLAS-R500	bended door leaf for Farfalla and Pillango h 2000 mm, R500	1/1
8147-1GLAS-R550	bended door leaf for Farfalla and Pillango h 2000 mm, R550	1/1

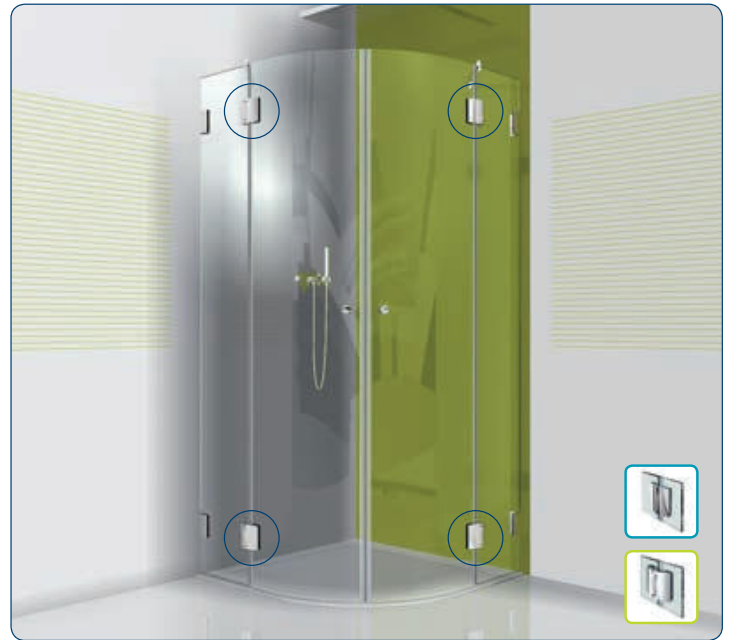

type 501



type 503



type 502

Additional and detailed information about curved glasses you will find in our technical catalogue accessories



glass processing:
tempered safety glass 6 mm, clear; 1 bore ø 14 mm;
4 bores ø 16 mm
all edges ground and polished



article no.	article name	pu/pieces
8146-1GLAS-R500	bended door leaf for Flinter, h 2000 mm, R500	1/1
8146-1GLAS-R550	bended door leaf for Flinter, h 2000 mm, R550	1/1

glass processing:
tempered safety glass 6 mm, clear; 1 bore ø 14 mm
all edges ground and polished



article no.	article name	pu/pieces
8145-1GLAS-R500	bended door leaf for Fluture, h 2000 mm, R500	1/1
8145-1GLAS-R550	bended door leaf for Fluture, h 2000 mm, R550	1/1



type 502

Additional and detailed information about curved glasses you will find in our technical catalogue accessories



type 502



overview sealing profiles and splash guards

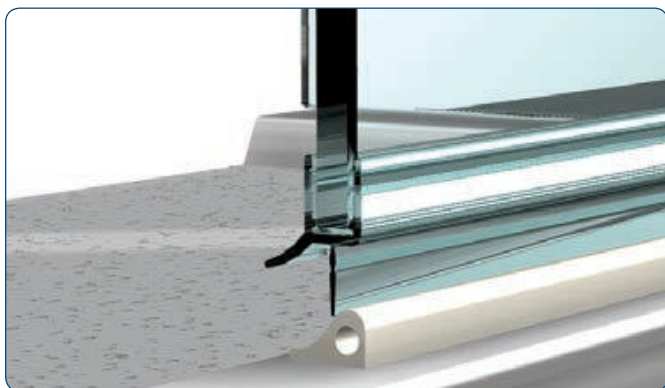

sealing profile with splash guard

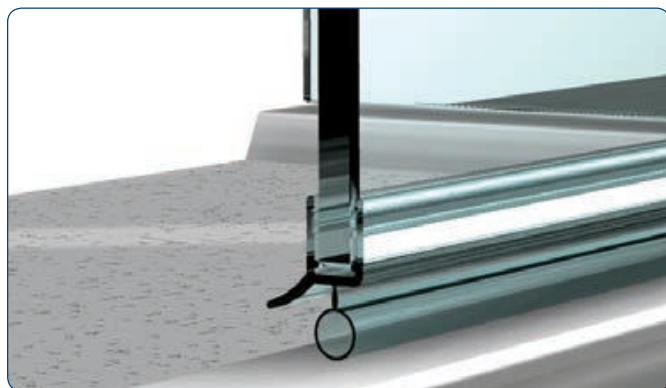

sealing profile without splash guard



sealing profile chrome design



magnetical sealing profile chrome design



sealing profile glass-wall



sealing profile glass-glass



overview sealing profiles and splash guards



splash guard

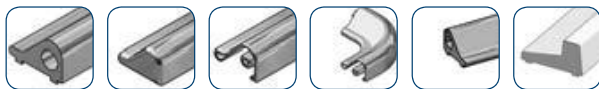

sealing profiles for shower door/tray

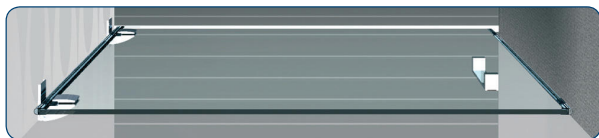
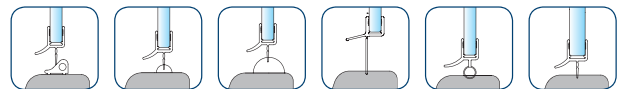

sealing profiles for shower door/wall

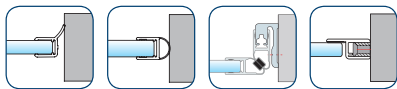

sealing profiles for glass-glass 90°

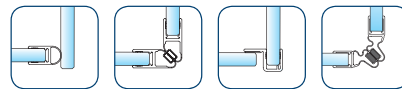

sealing profiles for glass-glass 135°

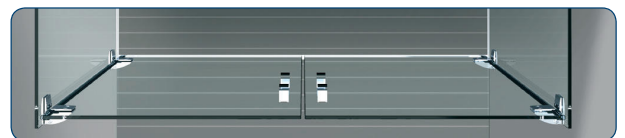
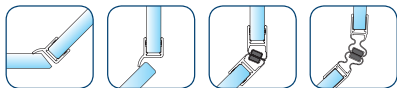

sealing profiles for glass-glass 180°

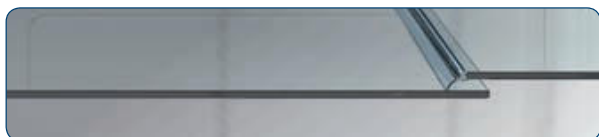
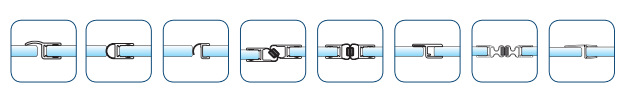

sealing profiles for glass-glass 180°, overlapping

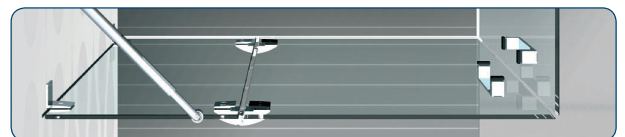

sealing profiles chrome decor



accessories – sealing profiles



for sealing profiles for shower door/tray

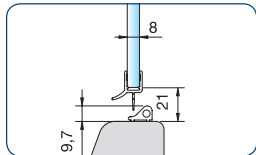

art. no. 8864KU0-8-2010
for 6 and 8 mm glass in
combination with splash guard
(art. no. 8535E6EV5)

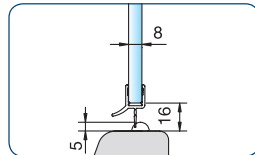

art. no. 8864KU0-8-2010
for 6 and 8 mm glass in combina-
tion with acrylic semi-circular rod
(art. no. 8538KU5, radius = 5 mm)

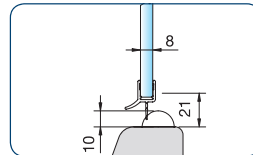

art. no. 8864KU0-8-2010
for 6 and 8 mm glass in combina-
tion with acrylic semi-circular rod
(art. no. 8539KU5, radius = 10 mm)

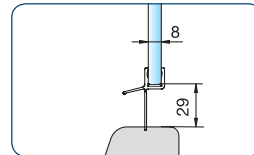

art. no. 8866KU0-8-2010
for 6 and 8 mm glass

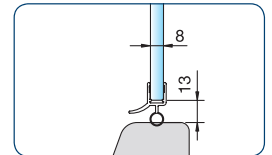

art. no. 8863KU0-8-2010
for 6 and 8 mm glass

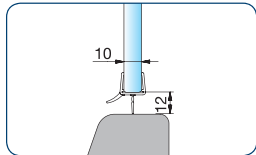

art. no. 8864KU0-12-2500
for 10 and 12 mm glass

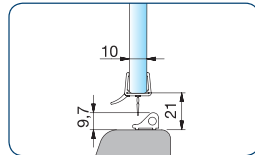

art. no. 8864KU0-12-2500
for 10 and 12 mm glass in
combination with splash guard
(art. no. 8535E6EV5)

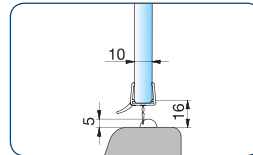

art. no. 8864KU0-12-2500
for 10 and 12 mm glass in combina-
tion with acrylic semi-circular rod
(art. no. 8538KU5, radius = 5 mm)

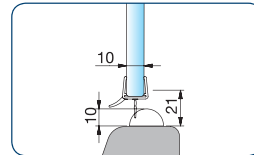

art. no. 8864KU0-12-2500
for 10 and 12 mm glass in combina-
tion with acrylic semi-circular rod
(art. no. 8539KU5, radius = 10 mm)

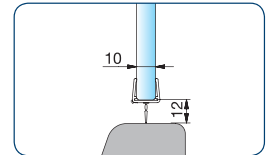

art. no. 8876KU0-12-2500
for 10 and 12 mm glass

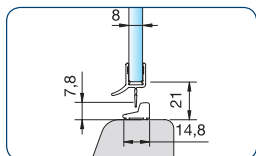

art. no. 8590E6EV5-2010
Splash guard in square design,
length 2010 mm with sealing profile
8864KU0-8-2010



Dichtprofile für den unteren Wannenanschluss, gebogen

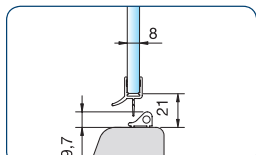

art. no. 8868KU0-8-R500
for 6 and 8 mm glass in combina-
tion with curved splash guard
for tuberadius R500-550
winding off = 1194 mm
(art. no. 8881 and 8882-R500)

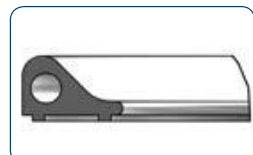
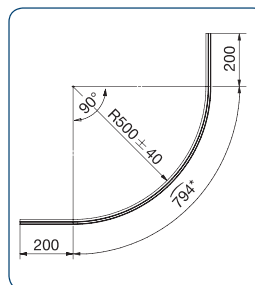

art. no. 8881E6/EV5-R500
art. no. 8882E6/EV5-R550
art. no. 8881E0/14-R500
art. no. 8882E0/14-R550

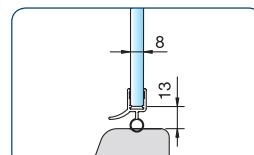

art. no. 8867KU0-8-R500
curved for tube radius
R500 - 550
for 6 and 8 mm glass
winding off = 1194 mm

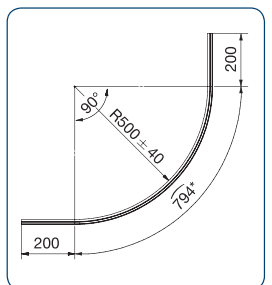

* außen

*article no. end: **E6/EV5**=aluminium special etched anodised bright chrome finish; **E0/14**=aluminium white powder coated, RAL 9016; **KU0** = plastic natural colour opaque
Please note: the mentioned reduction measurements are only valid for 8 or 10 mm glass! Reduction measurement for 6 or 12 mm glass on demand



sealing profiles for glass-glass 90°

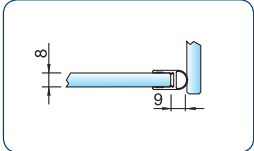

art. no. 8861KU0-8-2010
art. no. 8861KU0-8-2500
for 6 and 8 mm glass for an inward and outward opening shower hinge

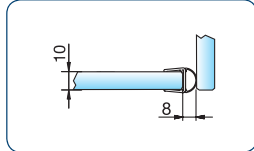

art. no. 8861KU0-12-2500
art. no. 8861KU0-12-3000
for 10 and 12 mm glass for an inward and outward opening shower hinge

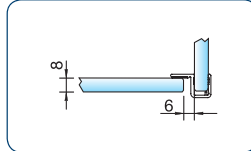

art. no. 8855KU0-8-2010
art. no. 8855KU0-8-2500
for 6 and 8 mm glass for an outward opening shower hinge

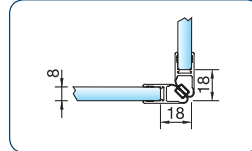

art. no. 8851KU0-8-2010
art. no. 8851KU0-8-2500
for 6 and 8 mm glass for an outward opening shower hinge

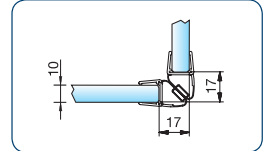

art. no. 8851KU0-12-2500
for 10 and 12 mm glass for an outward opening shower hinge



sealing profiles for glass-glass 135°

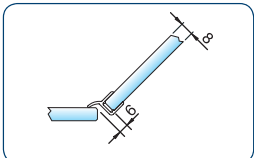

art. no. 8860KU0-8-2010
art. no. 8860KU0-8-2500
for 6 and 8 mm glass for an inward opening shower hinge

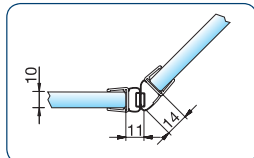

art. no. 8875KU0-12-2500
for 10 and 12 mm glass for an inward and outward opening shower hinge

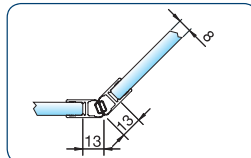

art. no. 8853KU0-8-2010
art. no. 8853KU0-8-2500
for 6 and 8 mm glass for an outward opening shower hinge

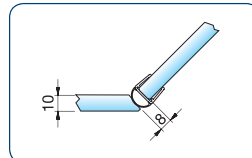

art. no. 8861KU0-12-2500
art. no. 8861KU0-12-3000
for 10 and 12 mm glass for a pendulum shower hinge

*article no. end: KU0 = plastic natural colour opaque

Please note: the mentioned reduction measurements are only valid for 8 or 10 mm glass! Reduction measurement for 6 or 12 mm glass on demand

accessories – sealing profiles



sealing profiles for glass-glass 180°

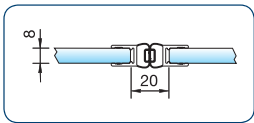

art. no. 8850KU0-8-2010
art. no. 8850KU0-8-2500
for 6 and 8 mm glass for a
pendulum shower hinge

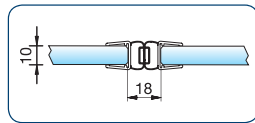

art. no. 8850KU0-12-2500
for 10 and 12 mm glass for a
pendulum shower hinge

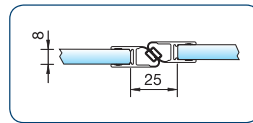

art. no. 8852KU0-8-2010
art. no. 8852KU0-8-2500
for 6 and 8 mm glass for a shower
hinge opening to one side

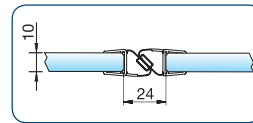

art. no. 8852KU0-12-2500
for 10 and 12 mm glass for a shower
hinge opening to one side

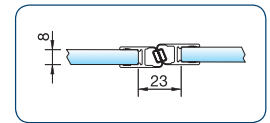

art. no. 8854KU0-8-2010
art. no. 8854KU0-8-2500
for 6 and 8 mm glass for a shower
hinge opening to one side

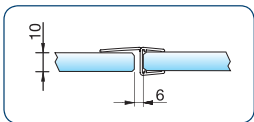

art. no. 8869KU0-12-2500
art. no. 8869KU0-12-3000
for 10 and 12 mm glass for a
shower hinge opening to one side

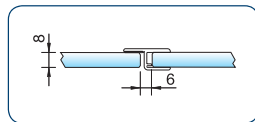

art. no. 8856KU0-8-2010
art. no. 8856KU0-8-2500
for 6 and 8 mm glass for a shower
hinge opening to one side

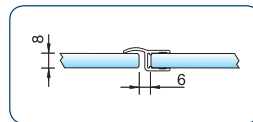

art. no. 8857KU0-8-2010
art. no. 8857KU0-8-2500
for 6 and 8 mm glass for a shower
hinge opening to one side

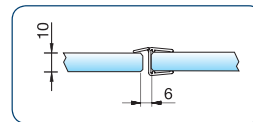

art. no. 8857KU0-12-2500
for 10 and 12 mm glass for a shower
hinge opening to one side

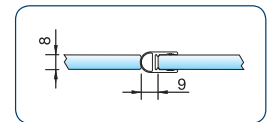

art. no. 8861KU0-8-2010
art. no. 8861KU0-8-2500
for 6 and 8 mm glass for a
pendulum shower hinge

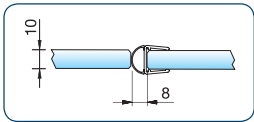

art. no. 8861KU0-12-2500
art. no. 8861KU0-12-3000
for 10 and 12 mm glass for a
pendulum shower hinge

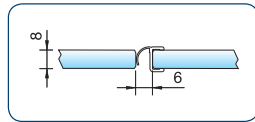

art. no. 8865KU0-8-2010
art. no. 8865KU0-8-2500
for 8 mm glass for a shower hinge
opening to one side



sealing profiles for glass-glass 180° overlapping

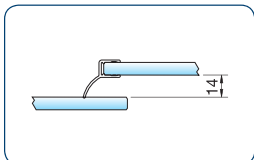

art. no. 8858KU0-8-2010
art. no. 8858KU0-8-2500
for 6 and 8 mm glass for an
outward opening shower hinge

*article no. end: KU0 = plastic natural colour opaque

Please note: the mentioned reduction measurements are only valid for 8 or 10 mm glass! Reduction measurement for 6 or 12 mm glass on demand



sealing profile for glass-glass, degree flexible

art. no. 8874KU0-8-2010
art. no. 8874KU0-8-2500
for 6 and 8 mm glass for an
outward opening shower hinge

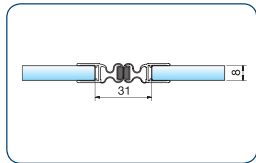

application 180°

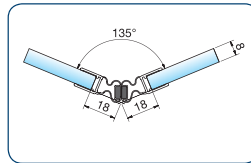

application 135°

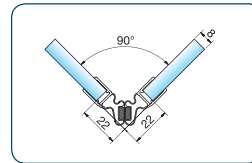

application 90°

reduction measurement 8 mm glass

installation angle	red. measure- ment
90°	22 mm
105°	23 mm
120°	19 mm
135°	18 mm
150°	16 mm
165°	16 mm
180°	15,5 mm

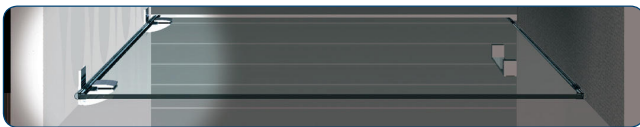

sealing profiles for door/wall 90° (hinge side)

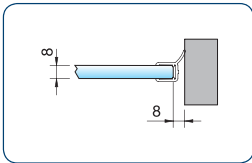

art. no. 8862KU0-8-2010
art. no. 8862KU0-8-2500
for 6 and 8 mm glass as a sealing
to the wall for an outward opening
shower hinge

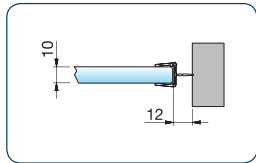

art. no. 8876KU0-12-2500
for 10 and 12 mm glass for a
pendulum shower hinge

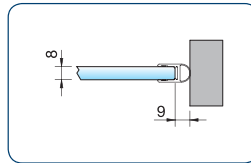

art. no. 8861KU0-8-2010
art. no. 8861KU0-8-2500
for 6 and 8 mm glass as a sealing
to the wall for an inward and outward
opening shower hinge

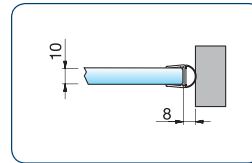

art. no. 8861KU0-12-2500
art. no. 8861KU0-12-3000
for 10 and 12 mm glass as a sealing
to the wall for an inward and
outward opening shower hinge

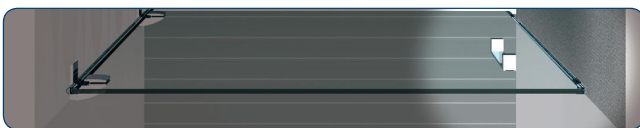

sealing profiles for door/wall 90° (handle side)

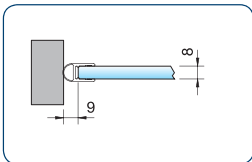

art. no. 8861KU0-8-2010
art. no. 8861KU0-8-2500
for 6 and 8 mm glass as a sealing
to the wall for a pendulum shower
hinge

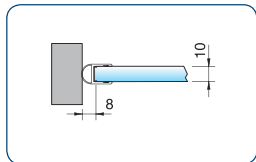

art. no. 8861KU0-12-2500
art. no. 8861KU0-12-3000
for 10 and 12 mm glass as a sealing
to the wall for a pendulum shower
hinge

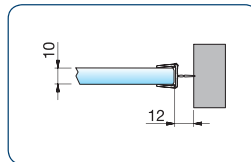

art. no. 8876KU0-12-2500
for 10 and 12 mm glass as a sealing
to the wall for a pendulum shower
hinge

*article no. end: KU0 = plastic natural colour opaque
Please note: the mentioned reduction measurements are only valid for 8 or 10 mm glass! Reduction measurement for 6 or 12 mm glass on demand

accessories – sealing profiles



carrier profile for door stop

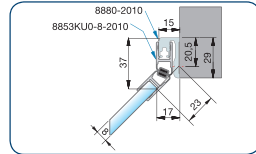
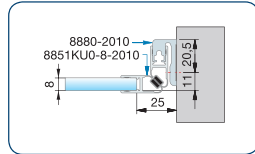
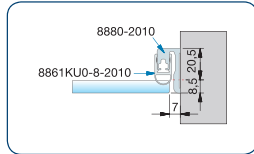
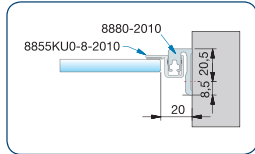
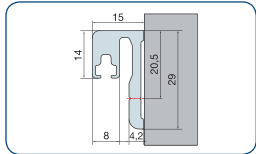

art. no. 8880 *-2010

length = 2010 mm, finished see article-no.-end

art. no. 8880 *-2500

length = 2500 mm, finished see article-no.-end

*article no. end: E6/EV1 = aluminium special etched anodised natural colour; E6/EV5 = aluminium special etched anodised bright chrome finish; E1/23 = aluminium ground anodised nickel silver (stainless steel finish); KU0 = plastic natural colour opaque



carrier profile for sealing profile

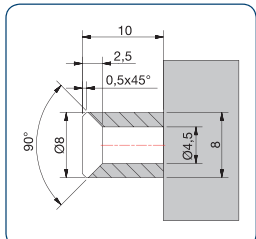

art. no. 8883E6EV1-8-2500

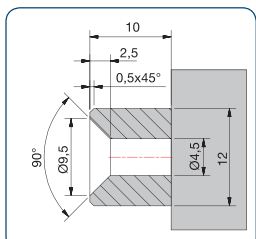

art. no. 8883E6EV1-12-2500

bore gaps

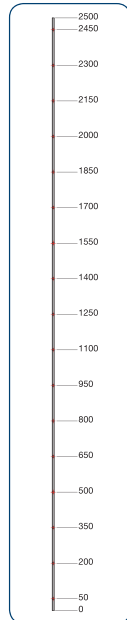

applications profile

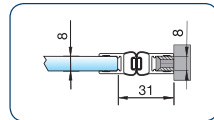

with sealing profile 8850KU-8 and carrier section 8883E6EV1-8

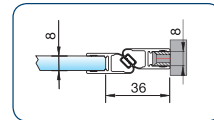

with sealing profile 8852KU-8 and carrier section 8883E6EV1-8

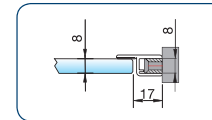

with sealing profile 8856KU-8 and carrier section 8883E6EV1-8

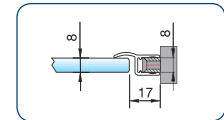

with sealing profile 8857KU-8 and carrier section 8883E6EV1-8

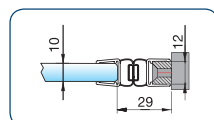

with sealing profile 8850KU-12 and carrier section 8883E6EV1-12

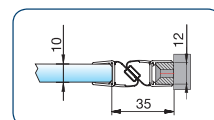

with sealing profile 8852KU-12 and carrier section 8883E6EV1-12

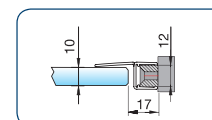

with sealing profile 8869KU-12 and carrier section 8883E6EV1-12

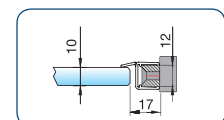

with sealing profile 8857KU-12 and carrier section 8883E6EV1-12

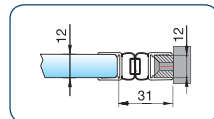

with sealing profile 8850KU-12 and carrier section 8883E6EV1-12

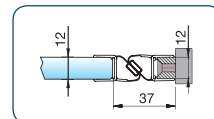

with sealing profile 8852KU-12 and carrier section 8883E6EV1-12

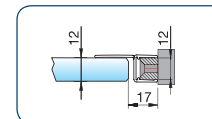

with sealing profile 8869KU-12 and carrier section 8883E6EV1-12

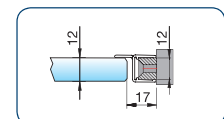

with sealing profile 8857KU-12 and carrier section 8883E6EV1-12

*article no. end: E6EV1 = aluminium special etched anodised natural colour

Please note: the mentioned reduction measurements are only valid for 8 or 10 mm glass! Reduction measurement for 6 or 12 mm glass on demand



Chrome design

sealing profiles chrome decor

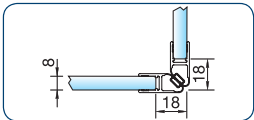

art. no. 8851KU7-8-2010
sealing profile for glass-glass 90°
for 6 und 8 mm glass for an inward
opening shower hinge

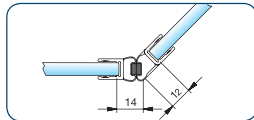

art. no. 8875KU7-8-2010
sealing profile for glass-glass 135°
for 6 and 8 mm glass for an inward
and outward opening shower hinge

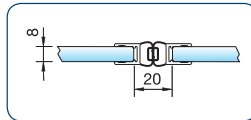

art. no. 8850KU7-8-2010
sealing profile for glass-glass 180°
for 6 and 8 mm glass for an inward
and outward opening shower hinge

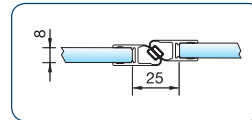

art. no. 8852KU7-8-2010
sealing profile for glass-glass 180°
for 6 and 8 mm glass for a shower
hinge opening to one side

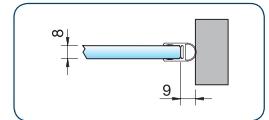

Art.-Nr. 8861KU7-8-2010
Dichtprofil für den seitlichen Wand-
anschluss 90° (Beschlagseite)
für 6 und 8 mm Glas für ein- und
beidseitig zu öffnendes Duschtürband

*article no. end: KU7=plastic bright chrome finish

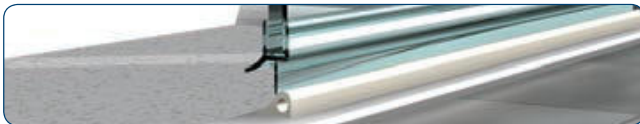

Schwallschutzprofile

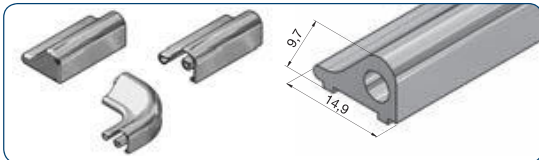

art. no. SET-8535E6/EV5-1860
art. no. SET-8535E0/14-1860
splash guard with a length of 1860 mm
incl. 1x end piece left, 1x end piece right, 1x splash guard corner 90°



art. no. SET-8536E6/EV5-90
art. no. SET-8536E0/14-90
1x end piece left, 1x end piece right, 1x splash guard corner 90°

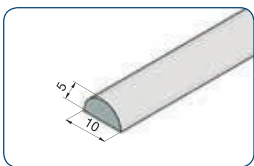

art. no. 8538KU5
splash guard with a length
of 2000 mm

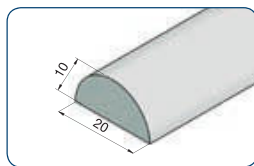

art. no. 8539KU5
splash guard with a length
of 2000 mm

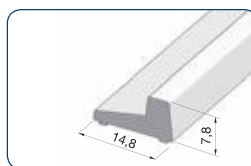

art. no. 8590E6/EV5-2010
splash protection profile square cut
length 2010 mm with sealing profile
8864KU0-8-2010

*article no. end: E6/EV5=aluminium special etched anodised bright chrome finish; E0/14=aluminium white powder coated, RAL 9016; KU5= plastic chrystal clear

Please note: the mentioned reduction measurements are only valid for 8 or 10 mm glass! Reduction measurement for 6 or 12 mm glass on demand

accessories – squared sealing profiles



cover cap and connector for square splash guards

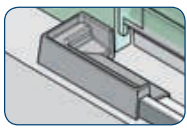

art. no. 8591KU7-L
cover cap left

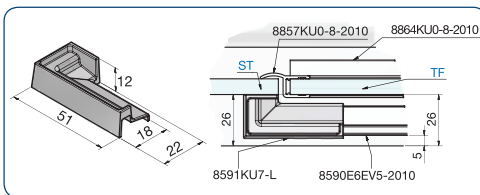

art. no. 8592KU7-R
90° cover cap right

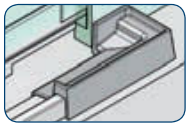
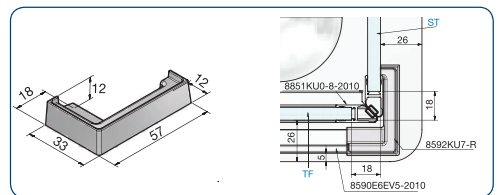

art. no. 8591KU7-R
cover cap right

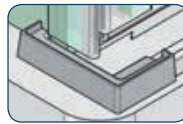
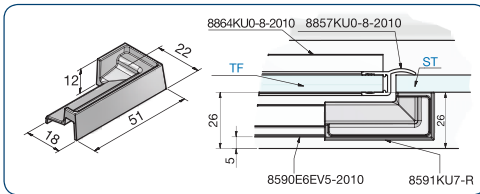

art. no. 8592KU7-L
90° cover cap left

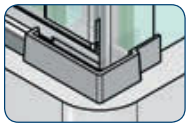
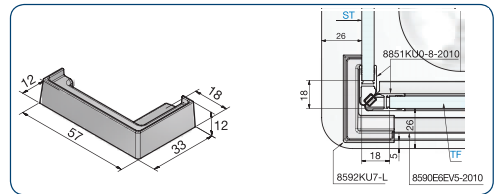

art. no. 8593KU7-R
90° connection side panel
splash guard right

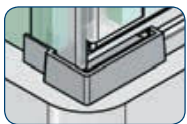
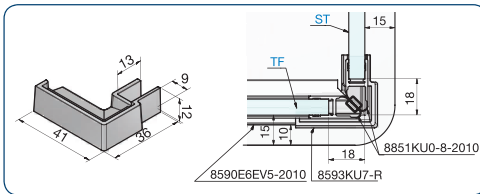

art. no. 8593KU7-L
90° connection side panel
splash guard left

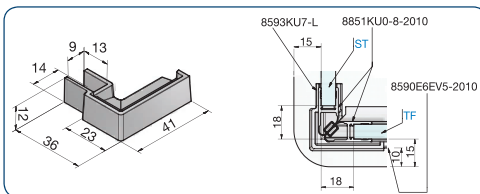

ST = side panel

TF = wing of the door

*article no. end: E6/EV5=aluminium special etched anodised bright chrome finish; KU0 = plastic natural colour opaque; KU7= plastic bright chrome finish



cover cap and connector for square splash guards

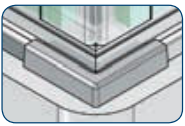

art. no. 8594KU7
90° corner connector

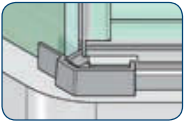
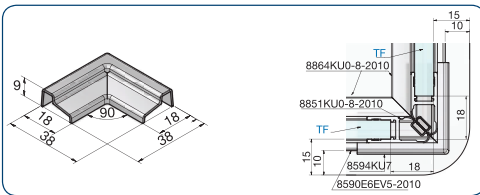

art. no. 8596KU7-L
pentagonal connector
left – door hinge left

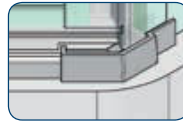
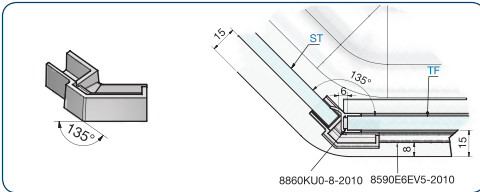

art. no. 8597KU7-R
pentagonal connector
right – door hinge left

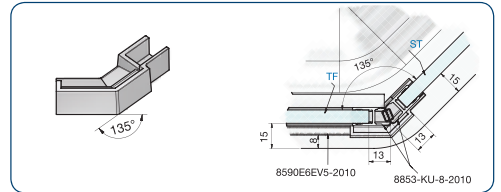

art. no. 8596KU7-R
pentagonal connector
right – door hinge right

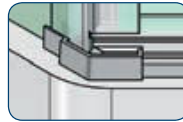
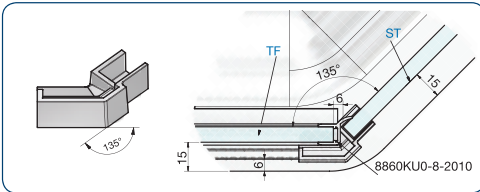

art. no. 8597KU7-L
pentagonal connector
left – door hinge right

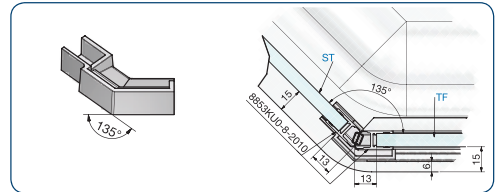

ST = side panel TF = wing of the door

*article no. end: E6/EV5=aluminium special etched anodised bright chrome finish; KU0 = plastic natural colour opaque; KU7 = plastic bright chrome finish



JOHN BERGER

Sales
Finland
Kuninkaanmäentie 120B
01260 Vantaa
+358 40 9008520
info@johnberger.fi
www.johnberger.fi

Estonia
Laki 9A
10621 Tallinn
+372 +372 654 6604
info@johnberger.ee
www.johnberger.ee